

A300

SHOTGUN
USER MANUAL



Contents

Basic Safety Rules.....	3
Nomenclature/Main Parts.....	8
Overview.....	11
Obstruction Check	13
Initial Assembly of Packaged Firearm	14
Checking the Condition of the Choke Tubes	17
Load Check.....	17
Safety.....	18
Ammunition.....	19
Using Your Firearm.....	20
How to Unload the Shotgun	22
A300 Ultima Disassembly	23
A300 Patrol Disassembly	27
Routine Maintenance	28
Recommended Storage Maintenance.....	29
A300 Ultima Reassembly	30
A300 Patrol Reassembly	33
Stock Drop and Cast Modification	34
Field Stripping.....	34
Storage	35
Warranty	35
Accessories	35
A300 Patrol Parts List.....	36
A300 Ultima Parts List.....	38

Titles:

Warning, Caution, and Notice headings are defined as follows:

**WARNING**

THE PURPOSE OF A WARNING TITLE IS TO DRAW ATTENTION TO POTENTIALLY DANGEROUS SITUATIONS THAT COULD RESULT IN PERSONAL INJURY.

**CAUTION**

A CAUTION concerns potential damage to the firearm.

**Notice**

A Notice highlights important procedures and statements that require more emphasis than general text.

Unless otherwise stated, the firearm described here is shown in the right-handed version. Text and illustrations are subject to change without prior warning.

 **WARNING**

THIS MANUAL CONTAINS IMPORTANT WARNINGS THAT NEED TO BE UNDERSTOOD BEFORE USING THIS FIREARM. PLEASE KEEP THIS COPY OF THE INSTRUCTION MANUAL FOR FUTURE CONSULTATION. IN CASE OF CHANGE OF OWNERSHIP, ALWAYS PROVIDE A COPY OF THIS MANUAL. IF THIS FIREARM IS LOANED, GIVEN TO OTHERS TO USE, OR SOLD ON, MAKE SURE THAT THIS INSTRUCTION MANUAL ACCOMPANIES IT AS A REFERENCE FOR SAFETY PROCEDURES AND OPERATION.

 **WARNING**

FIREARMS CAN BE DANGEROUS AND CAN POTENTIALLY CAUSE SERIOUS INJURY, DAMAGE TO PROPERTY OR DEATH IF HANDLED IMPROPERLY. THE FOLLOWING SAFETY RULES ARE AN IMPORTANT REMINDER THAT YOU ARE RESPONSIBLE FOR THE SAFETY OF YOUR FIREARM.

 **WARNING**

ALWAYS MAKE SURE THAT THE SAFETY IS FULLY ENGAGED UNTIL YOU ARE READY TO SHOOT. CAREFULLY READ THE "SAFETY" CHAPTER IN THIS MANUAL BEFORE BEGINNING TO HANDLE THE FIREARM.

 **WARNING**

CAREFULLY READ ALL PARTS IN THE MANUAL BEFORE USING THIS FIREARM. MAKE SURE THAT ANY PERSON USING OR HAVING ACCESS TO THIS FIREARM HAS READ AND COMPLETELY UNDERSTOOD ALL OF THE INSTRUCTIONS IN THIS MANUAL PRIOR TO USE OR ACCESS.

WE RECOMMEND THE USE OF ORIGINAL BERETTA SPARE PARTS AND ACCESSORIES. THE USE OF SPARE PARTS AND ACCESSORIES FROM OTHER MANUFACTURERS COULD CAUSE MALFUNCTIONS AND/OR BREAKAGES THAT WILL NOT BE COVERED BY THE BERETTA WARRANTY.

 **WARNING**

BERETTA AND/OR ITS LOCAL OFFICIAL DISTRIBUTORS ASSUME NO LIABILITY FOR PRODUCT MALFUNCTION OR FOR PHYSICAL INJURY OR DAMAGE TO PROPERTY RESULTING IN WHOLE OR IN PART FROM CRIMINAL OR NEGLIGENT USE OF THE PRODUCT, IMPROPER OR CARELESS HANDLING, INTENTIONAL OR ACCIDENTAL DISCHARGE, UNAUTHORIZED MODIFICATIONS, USE OF DEFECTIVE, IMPROPER, HAND-LOADED, RELOADED OR REMANUFACTURED AMMUNITION, MISUSE OR NEGLECT OF THE PRODUCT, OR OTHER FACTORS BEYOND MANUFACTURER'S DIRECT AND IMMEDIATE CONTROL.

IN ADDITION TO THE BASIC SAFETY RULES, THERE ARE OTHER SAFETY RULES PERTAINING TO THE LOADING, UNLOADING, DISASSEMBLY, ASSEMBLY AND USE OF THIS FIREARM, LOCATED THROUGHOUT THIS MANUAL.

BASIC SAFETY RULES

1. NEVER POINT A FIREARM AT SOMETHING THAT IS NOT SAFE TO SHOOT.

Never let the muzzle of a firearm point at any part of your body or at another person. This is especially important when loading or unloading the firearm. When you are shooting at a target, know what is behind it. Some bullets can travel over a mile. If you miss your target or if the bullet penetrates the target, it is your responsibility to ensure that the shot does not cause unintended injury or damage.



2. ALWAYS HANDLE A FIREARM AS IF IT WERE LOADED.

Never assume that a firearm is unloaded. The only certain way to ensure there are no cartridges in a firearm is to open the chamber and visually and physically examine the inside to see if a round is present. Removing or unloading the magazine will not guarantee that a firearm is unloaded or cannot fire. Firearms can be checked by cycling or removing rounds and by then opening the chamber so that a visual inspection of the chamber for any remaining rounds can be made.

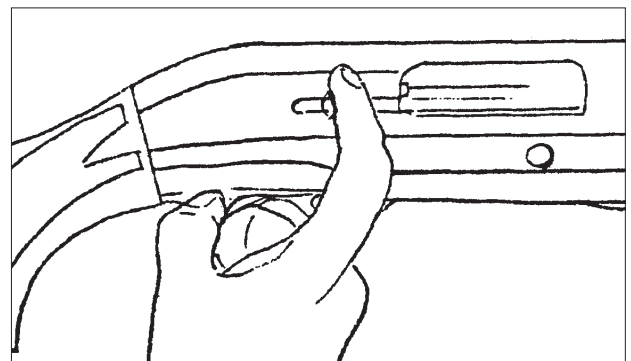
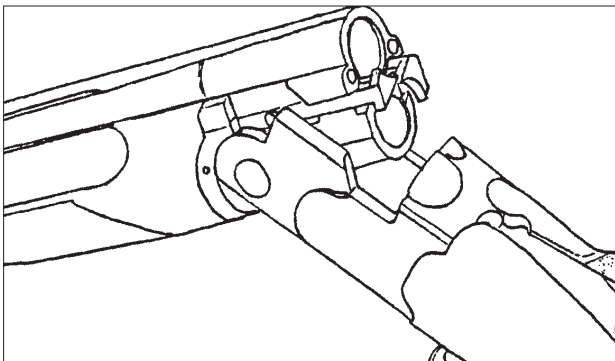
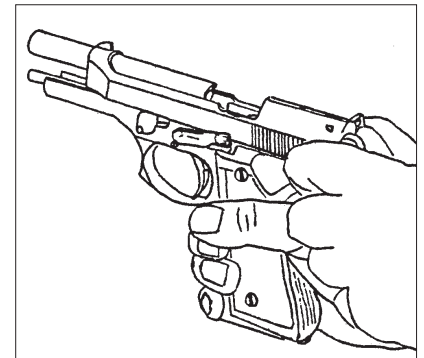

3. STORE YOUR FIREARM SO THAT IT IS WELL OUT OF CHILDREN'S REACH.

It is your responsibility to ensure that children under the age of 18 or other unauthorized persons cannot gain access to your firearm. To reduce the risk of accidents involving children, unload your firearm, lock it in a safe place, and store the ammunition in a separate locked location. Please note that devices intended to prevent accidents such as: cable locks, chamber plugs, etc., may not prevent use or misuse of your firearm by a determined person. Firearm storage in a steel gun safe may be more appropriate to reduce the likelihood of intentional misuse of a firearm by a child or unauthorized person.

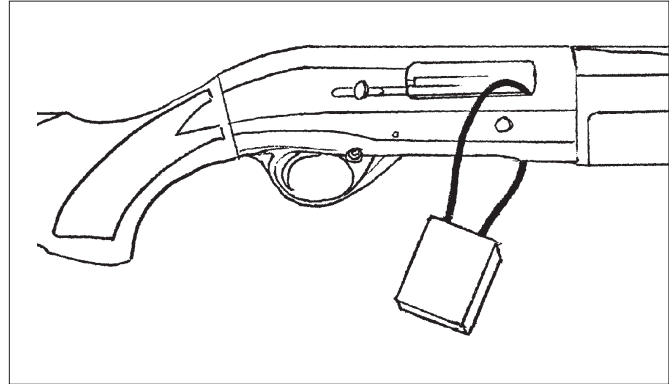
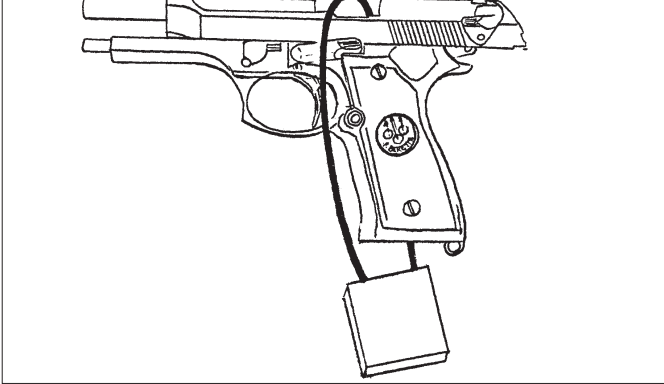

4. NEVER SHOOT AT WATER OR AT HARD SURFACES.

Shooting at the surface of water or at a rock or other hard surface increases the chance of ricochets or fragmentation of the bullet or shot, which can result in the projectile striking an unintended or peripheral target.



5. MAKE SURE YOU KNOW THE SAFETY FEATURES OF THE FIREARM YOU ARE USING, BUT REMEMBER: SAFETY DEVICES ARE NOT A SUBSTITUTE FOR SAFE HANDLING PROCEDURES.

Never rely solely on a safety device to prevent an accident. It is imperative that you know and use the specific safety devices of the particular firearm you are handling, but the best way to prevent accidents is to follow the safe handling procedures described in these safety rules and elsewhere in the product manual. To further familiarize yourself with the proper use of this or other firearms, take a Firearms Safety Course taught by an expert in firearm use and safety procedures.

6. PROPERLY MAINTAIN YOUR FIREARM.

Store and carry your firearm so that dirt or lint does not accumulate in the working parts. Clean and oil your firearm after each use, following the instructions provided in this manual, to prevent corrosion, damage to the barrel or the accumulation of impurities which can prevent use of the firearm in an emergency. Always check the barrel and chamber(s) before loading to ensure that they are clean and free from obstructions. Firing with an obstruction in the barrel or chamber can rupture the barrel and injure you or others nearby. In the event you hear an unusual noise when shooting, stop firing immediately, engage the manual safety and unload the firearm. Make sure the chamber and barrel are free from any obstruction, such as a bullet blocked inside the barrel due to defective or improper ammunition.



7. USE SUITABLE AMMUNITION.

Only use factory-loaded, new ammunition manufactured to industry specifications: CIP (Europe and elsewhere), SAAMI® (U.S.A.). Be certain that every round you use is in the proper caliber and type for the particular firearm. The caliber of the firearm is clearly marked on the barrel. The use of reloaded or remanufactured ammunition can increase the likelihood of excessive cartridge pressures, case-head ruptures or other defects in the ammunition that can cause damage to your firearm and injury to yourself or others nearby.

8. ALWAYS WEAR PROTECTIVE GLASSES AND EARPLUGS WHEN SHOOTING.

The chance that gas, gunpowder residue or metal fragments will blow back and injure a shooter who is firing a gun is rare; however, the injury that can be sustained in such circumstances can be severe, including the possible loss of eyesight. A shooter must always wear impact-resistant shooting glasses when firing any firearm. Noise-reducing earplugs or headphones will reduce the risk of damage to hearing caused by prolonged shooting activity.



9. NEVER CLIMB A TREE, FENCE OR OBSTRUCTION, AND NEVER JUMP OVER DITCHES WITH A LOADED FIREARM.

Open and empty the chamber(s) of your firearm and engage the manual safety before climbing up or down a tree, climbing a fence or jumping over a ditch or other obstruction. Never pull or push a loaded firearm toward yourself or another person. Always unload a firearm, then visually and physically check to make sure that the magazine, loading mechanism and chamber(s) are unloaded, and the action is open before handing it to another person. Never take a firearm from another person unless it is unloaded, and was visually and physically checked to confirm it is unloaded.



10. AVOID ALCOHOLIC BEVERAGES OR JUDGEMENT/REFLEX IMPAIRING MEDICATION WHEN SHOOTING.

Never drink and shoot. If you take medication that can impair motor reactions or judgment, do not handle a firearm while you are under the influence of this medication.



11. NEVER TRANSPORT A LOADED FIREARM.

Always unload a firearm before putting it in a vehicle (chamber empty, magazine empty). Hunters and target shooters should load their firearm only at their destination, and only when they are ready to shoot. If you carry a firearm for self-protection, leaving the chamber unloaded can reduce the chance of unintentional discharge.

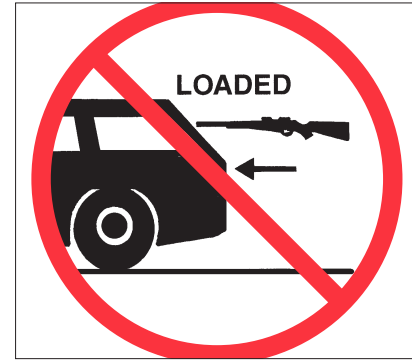
**12. LEAD WARNING.**

Discharging firearms in poorly ventilated areas, cleaning firearms, or handling ammunition may result in exposure to lead and other substances known to cause birth defects, reproductive harm, and other serious physical injury. Always use a firearm in a suitably ventilated area. Wash hands thoroughly after exposure to these substances.



It is your responsibility to know and abide by federal, state and local laws governing the sale, transportation and use of firearms in your area.



THIS FIREARM HAS THE CAPABILITY OF TAKING YOUR LIFE OR THE LIFE OF SOMEONE ELSE!

ALWAYS BE EXTREMELY CAREFUL WITH YOUR FIREARM.

AN ACCIDENT IS ALMOST ALWAYS THE RESULT OF NOT FOLLOWING BASIC FIREARM SAFETY RULES.

BEFORE USING THE FIREARM OR CARRYING OUT ANY OPERATION IN THIS MANUAL, BE SURE TO CAREFULLY FOLLOW THE BASIC SAFETY RULES INDICATED ABOVE.



ALWAYS ENSURE THAT THE SAFETY IS FULLY ENGAGED UNTIL READY TO FIRE.



The Manufacturer and/or its Local Official Distributors assume no liability for product malfunction or for physical injury or property damage resulting in whole or in part from criminal or negligent use of the product, improper or careless handling, unauthorized modifications, use of defective, improper, hand-loaded, reloaded or remanufactured ammunition, customer misuse or neglect of the product, or other factors beyond manufacturer's direct and immediate control. In addition to the Basic Safety Rules, there are other Safety Rules pertaining to the loading, unloading, disassembly, assembly and use of this firearm, located throughout this manual.



MAKE SURE THAT ANY PERSON USING OR HAVING ACCESS TO THIS FIREARM READS AND UNDERSTANDS THIS ENTIRE MANUAL PRIOR TO USE OR ACCESS.

 **Notice**

As the interchangeable barrel of this shotgun has a serial number different from that stamped on the receiver, it may be necessary, when referring to the gun, to specify also the serial number of the barrel(s).

IMPORTANT: WE RECOMMEND THE USE OF ORIGINAL BERETTA SPARE PARTS AND ACCESSORIES. THE USE OF OTHER MANUFACTURER'S SPARE PARTS AND ACCESSORIES COULD CAUSE MALFUNCTIONS AND/OR DAMAGE THAT WILL NOT BE COVERED BY THE BERETTA WARRANTY.

 **WARNING**

DO NOT ATTEMPT TO LOAD MORE CARTRIDGES INTO YOUR BERETTA SHOTGUN THAN LOCAL LEGISLATION PERMITS. BERETTA WILL NOT BE HELD RESPONSIBLE FOR ANY PRODUCT MALFUNCTION, PROPERTY DAMAGE, PHYSICAL INJURY OR LEGAL REPERCUSSIONS WHICH HAVE BEEN CAUSED THROUGH NOT ABIDING BY THE LOADING INSTRUCTIONS AS STATED IN THE BERETTA PRODUCT MANUAL. LITERATIONS OR ADJUSTMENTS (NOT CONTEMPLATED BY THE MANUFACTURER) TO ANY PART OF THE SHOTGUN WHICH CHANGE THE AMMUNITION CAPACITY VOIDS THE MANUFACTURER'S WARRANTY.

NOMENCLATURE/MAIN PARTS

A300 ULTIMA

- | | |
|------------------------------------|---------------------------------|
| 1 Recoil pad and kickoff assembly | 16 Breech bolt release button |
| 2 Stock | 17 Loading gate |
| 3 Receiver | 18 Carrier |
| 4 Breech bolt assembly | 19 Carrier stop push button |
| 5 Stepped top rib | 20 Safety button |
| 6 Front sight | 21 Trigger |
| 7 Muzzle | 22 Trigger guard |
| 8 Barrel | 23 Mobilchoke® tube |
| 9 Sling swivel | 24 Choke tube wrench |
| 10 Forend cap | 25 Barrel tang |
| 11 Forend | 26 Gas cylinder |
| 12 Sling swivel | 27 Exhaust valve |
| 13 Trigger guard retaining pin | 28 Piston |
| 14 Cocking handle | 29 Magazine tube |
| 15 Ejection port/cartridge chamber | 30 Magazine tube cap with shaft |

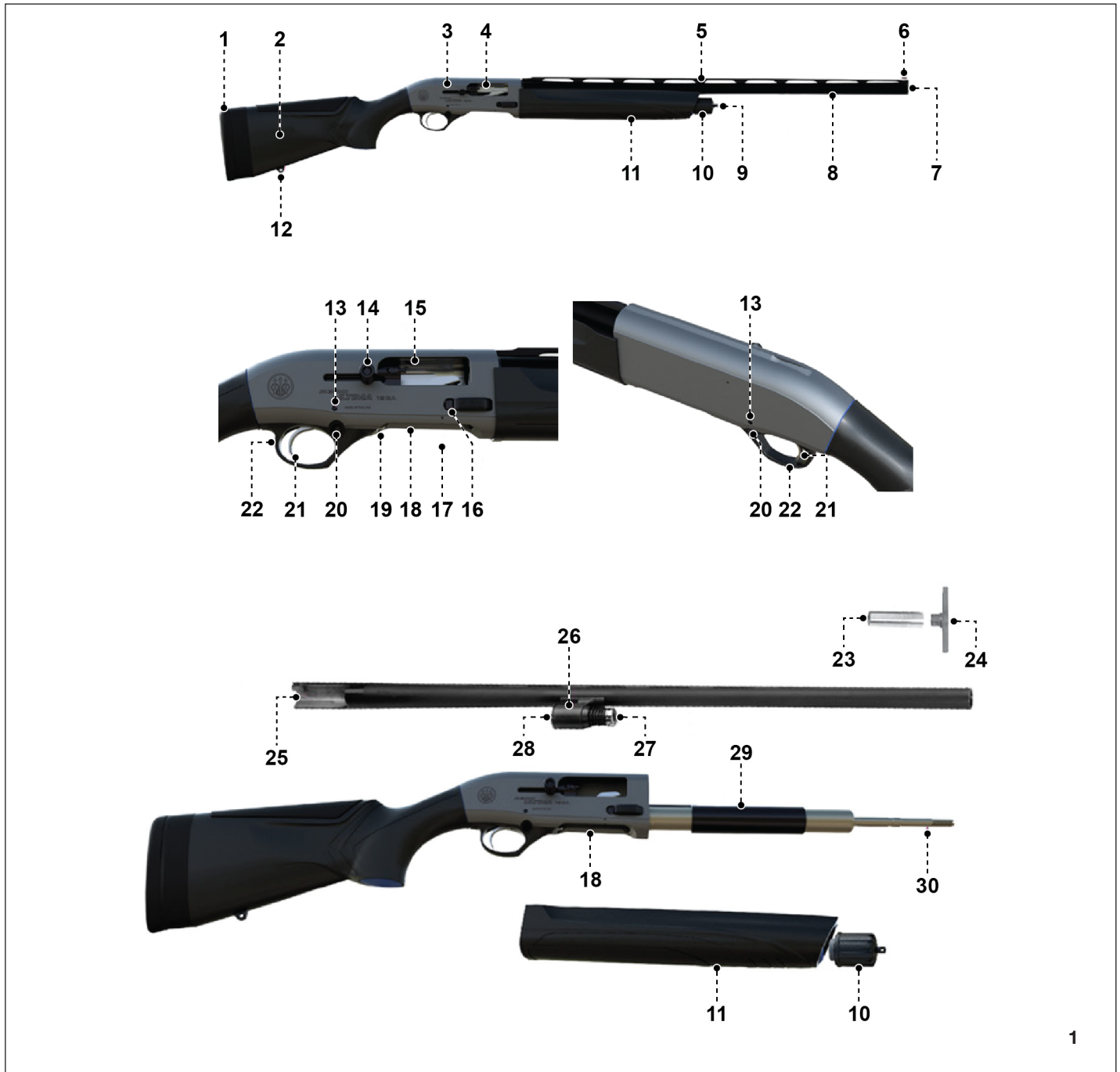

A300 PATROL

- | | |
|---|---------------------------------------|
| 1 Recoil pad | 16 Carrier |
| 2 Stock | 17 Carrier stop push button |
| 3 Receiver | 18 Safety button |
| 4 Fixed combat sights | 19 Trigger |
| 5 Picatinny rail | 20 Trigger guard |
| 6 Barrel assembly | 21 Trigger guard retaining pin |
| 7 Muzzle | |
| 8 Forend cap | |
| 9 Barrel clamp assembly | |
| 10 Forend | |
| 11 Breech bolt release button | |
| 12 Bolt assembly | |
| 13 Trigger guard retaining pin | |
| 14 Ejection port/cartridge chamber | |
| 15 Cocking handle | |

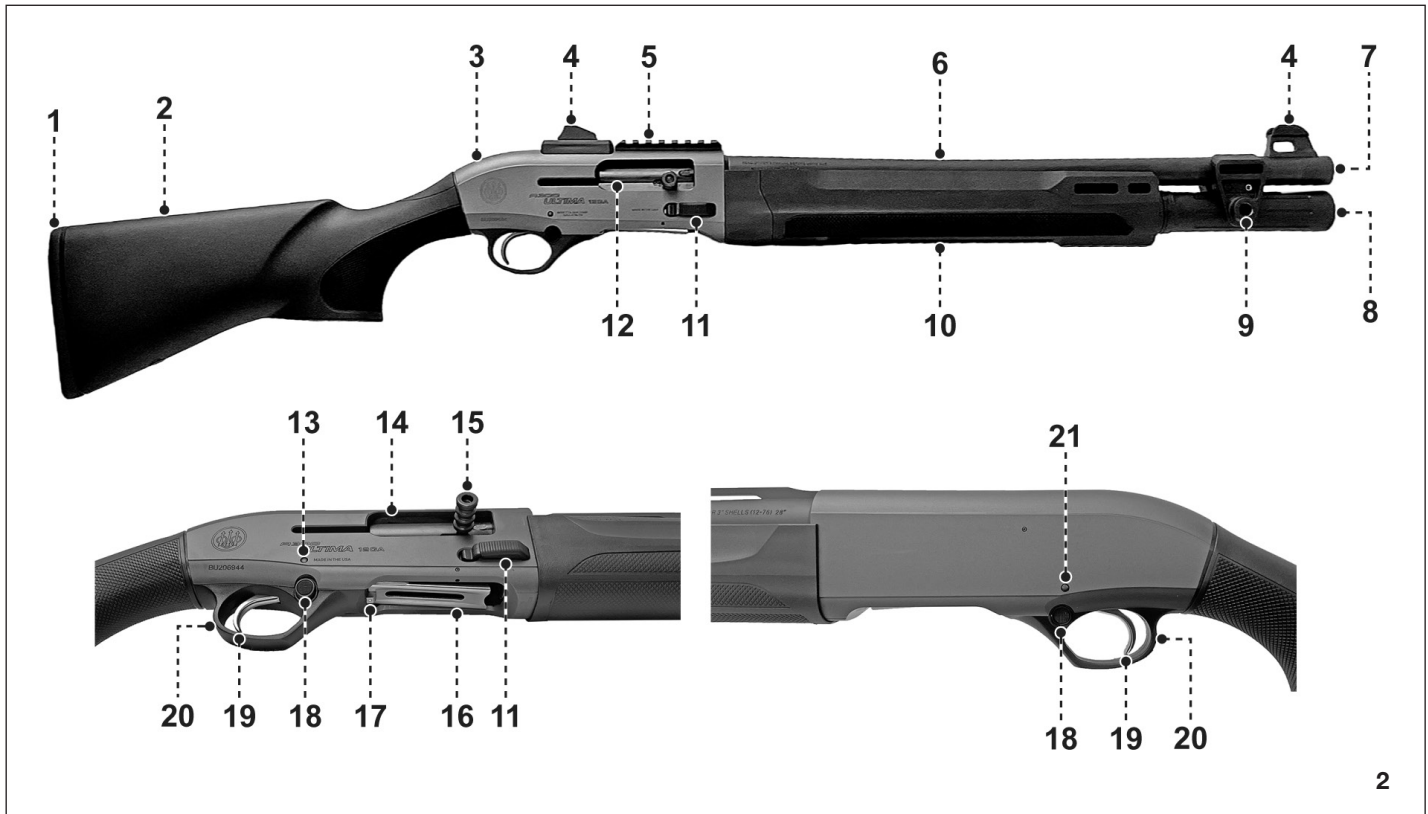

OVERVIEW

The A300 Ultima is the latest evolution in the Beretta 300 series line of shotguns; bringing the Beretta premium shotgun shooting experience to a more attainable level than ever before. In keeping with the Beretta tradition, the new A300 Ultima is a soft-shooting, gas-operated system semi-automatic, which combines the reliable Beretta bolt with falling block (locked breech) with an improved gas valve with a self-cleaning cylinder and piston, so that excess pressure caused by the most powerful cartridges can be decreased automatically.

DESCRIPTION

A300 Ultima

Like all Beretta Shotguns, the rugged A300 Ultima is elegant, yet efficient; sleek, yet strong; with rolling, graceful lines that give the Ultima a distinctive look.

The receiver is precisely machined from a solid block of light alloy aluminum and is assembled with care, checked and cycled to ensure reliable operation. All metal parts are protected by finishes against wear and tear, and rusting. The A300 Ultima receiver has undergone an anodic oxidation process that protects the firearm from corrosion and scratching.

The trigger guard is made of heavy duty polymer. Its new semi-square shape makes finger positioning easier. The use of a technopolymer ensures that the color will remain in the parts traditionally subject to rubbing while at the same time enhancing sensitivity of touch in cold climates. The opening of the trigger guard is bigger so the trigger is accessible even to a gloved hand.

The carrier and bolt are finished to resist rust and wear, and are a proven durable and reliable system.

The safety button offers a wider, textured surface for easier operation. To help prevent accidental engaging or disengaging, the safety is protected and topped by a protruding edge. The safety button can be reversed for left-handed shooters.

The forend has long, slender contours that add to the distinctness of the A300 Ultima’s overall design. The cap has a polymer structure that makes it very lightweight and is weather and rust-resistant. In front of the forend cap there is a practical swivel stud.

The contoured stock provides superior comfort and a secure grip to ensure the highest performance during firing. Made of sturdy polymer with an elastomer cheek piece (not available in Patrol versions), its grip contour is ambidextrous, with adjustable shims for cast on or cast off. The stock houses a Beretta Kickoff ® recoil-reducing system, making the Ultima an even softer shooting gun than its predecessor.

A300 Patrol

The Beretta A300 Patrol is a self defense and tactical shotgun designed using the same mechanism that can be found in the rest of the A300 line. Its loading, unloading and maintenance are identical to the rest of the A300 family as detailed in this manual.

The A300 Patrol has a unique enlarged loading port which makes loading this firearm easier, particularly with gloves. The Patrol version also features a modular ghost ring rear combat sight and a serviceable front sight post.

The receiver is also equipped with a 7 Slot 1913 Picatinny optics rail mount.

The forend features (3) M-Lok mounting points for attaching accessories.

Note: The A300 Patrol is capable of holding 7 rounds of 2 3/4" shot shells and is not recommended for hunting applications.

Note: The A300 Patrol forend is unique from the rest of the A300 family of shotguns. The assembly and disassembly of this forend is slightly different and is designed to allow a flush fit to the receiver. See "A300 Patrol Disassembly" page 27 for more information.

CAUTION

If you choose to apply loop pads to the side of the A300 Patrol, removal may damage the receiver finish.

CAUTION

Firing slugs and buck shot through the A300 Patrol can result in lead buildup in the gas operating system. Beretta recommends cleaning the gas cylinder, piston, ring, and barrel after every 200 rounds to ensure reliable function when firing these types of ammunition. See "Routine Maintenance" page 28 for more information.

REDUCED NUMBER OF COMPONENTS

The Beretta semi-automatic A300 Ultima has a particularly small number of assemblies. The shotgun is composed of five main assembly groups which can be field stripped by the user for quick and easy disassembly. A firearm that can be easily taken apart is also easier to clean. Easy cleaning encourages the user to perform more careful maintenance on the firearm, ensuring long-term reliability.

GAS-OPERATED SYSTEM WITH EXHAUST VALVE

The patented gas-operated system with a self-cleaning cylinder and piston, has a compensating exhaust valve so that excess pressure caused by the most powerful cartridges can be decreased automatically. As a result, the shotgun, without any adjustment or intervention, can shoot cartridges from 70 mm (2 3/4 in) /24 g (7/8 oz) to 76 mm (3 in) /57 g (2 oz).

The semi-automatic, gas-operated A300 Ultima has been optimized to ensure lower gas dispersal. As a result, the system has a self-cleaning feature that further minimizes maintenance and significantly reduces the stress to which the operating parts are subjected to at higher pressures; thereby, ensuring the greatest possible service life of the firearm.

The piston has been designed to constantly clean out gunpowder residue in the cylinder, increasing the efficiency of the firearm and reducing the need for frequent maintenance. The elastic piston seal has a rough finish to optimize cleaning.

WARNING

SHOTGUN ASSEMBLY WARNING: IN ORDER TO PREVENT DAMAGE TO THE ELASTIC PISTON SEAL, FIRST PINCH THE PISTON SEAL TOGETHER WHILE INSERTING THE PISTON INTO THE CHAMBER CYLINDER AND THEN INSERT THE MAGAZINE TUBE CAP SHAFT THROUGH THE PISTON HOLE.

The valve unit is connected to the barrel, making assembly and disassembly of the barrel itself easier.

MOBILCHOKE® BARREL / MOBILCHOKE® TUBES

The barrel of the new Beretta semi-automatic A300 Ultima is exceptionally robust and lightweight at the same time. Designed for use with steel shot cartridges, it has a Mobilchoke® internal profile.

The Beretta Mobilchoke® internal choke tubes are designed to reduce shot deformation and to enhance shot pattern distribution and concentration. Made of high performance plated steel, the Beretta Mobilchoke® choke tubes ensure the highest protection against rust and resistance to use of steel shot.

WARNING

THE BARREL OF THE A300 ULTIMA CAN ONLY MOUNT MOBILCHOKE® TYPE TUBES. OTHER TYPES OF INTERCHANGEABLE BERETTA CHOKE TUBES ARE NOT APPROPRIATE FOR USE WITH A300 ULTIMA BARREL AND THESE WILL ALTER THE SHOT PATTERN DISTRIBUTION AND CAN CAUSE SEVERE DAMAGE TO THE BARREL.

Beretta Mobilchoke® Tubes

Beretta Markings	American Designations	Compatibility with Steel Shot	Notches
0(*)	F (Full)	SP (Steel Proof)(1)	I
00(**)	IM (Improved Modified)	SP (Steel Proof)(1)	II
000(***)	M (Modified)	SP (Steel Proof)	III
0000(****)	IC (Improved Cylinder)	SP (Steel Proof)	IIII
C00000 (C****)	CL (Cylinder)	SP (Steel Proof)	IIII I

(1) Not recommended for steel shot. Mobilchoke® is a registered trademark of Fabbrica d'Armi Pietro Beretta S.p.A.



CAUTION
Beretta recommends patterning and targeting any regularly used ammo/choke combinations to understand what works best for your barrel.

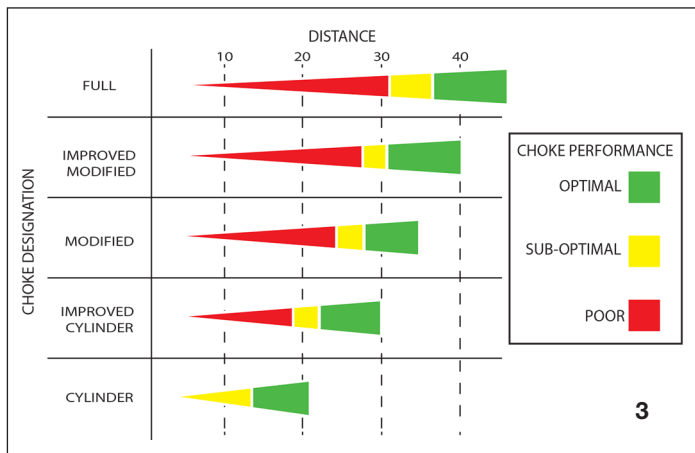

MAGAZINE CAPACITY**

A300 Ultima

The magazine has a two-shot capacity*, in line with current hunting regulations in many countries, made possible by the insertion of a reducer plug. This reducer restricts firearm use to no more than three shots (two in the magazine, and one in the cartridge chamber). This device is fitted by Beretta during manufacturing and assembly of the A300 Ultima. In certain specific areas, hunting is only authorized with firearms of no more than two rounds. To use the A300 Ultima in these regions, the magazine capacity must be limited to a single shot with a reducer plug (operation to be performed by a competent gunsmith).

See “Ammunition” page 19 for more information.

A300 Patrol

The A300 Patrol is capable of holding 7+1 rounds of 2 3/4” shot shells and is not recommended for hunting applications.

See “Ammunition” page 19 for more information.

DATA AND TECHNICAL CHARACTERISTICS

Gauge	12 or 20
Cartridge chamber	2 3/4” or 3” (70mm to 76mm)
Operation	Semi-automatic, gas operation with exhaust valve
Locking system	Elevated locking block
Receiver	Aluminum alloy
Barrel	Steel
Sights	Fiber Optic front and steel midbead on a stepped rib A300 Patrol includes fixed combat sights
Safety	Button-operated, on trigger guard. Reversible for left-handed shooters.
Magazine	2+1 with plug installed**
Stock	Walnut or synthetic, ambidextrous with adjustment. Rubber recoil pad + Kickoff®
Length of pull	13” - 14.5”
Chokes	IC - M - F

** Ammunition capacity in the A300 Patrol differs. See “Magazine Capacity***” page 13 for more information.

OBSTRUCTION CHECK

Check the barrel to ensure there are no obstructions in the chamber and bore. This is extremely important because serious injury can result to the user or to nearby persons if a cartridge is fired in an obstructed barrel or chamber.



THE BARREL MUST BE INSPECTED EVERY TIME BEFORE YOU USE THE FIREARM.

Proceed as follows:

Remove the barrel from the shotgun. See “Removal of Barrel” page 24 or “A300 Patrol Disassembly” page 27 for more information.

After removing the barrel, look through the barrel from the rear and make sure there are no obstructions, even minor ones. See “Obstruction Check” page 13 for more information.

If an obstruction in the barrel is detected, a competent gunsmith must remove the obstruction. Inspect the shotgun again before it can be fired.

Install the barrel to the shotgun. See “Installation of Barrel” page 30 or “A300 Patrol Reassembly” page 33 for more information.

INITIAL ASSEMBLY OF PACKAGED FIREARM

! WARNING

THIS FIREARM HAS THE CAPABILITY OF TAKING YOUR LIFE OR THE LIFE OF SOMEONE ELSE! ALWAYS BE VERY CAREFUL WHEN HANDLING YOUR FIREARM. AN ACCIDENT IS NEARLY ALWAYS THE RESULT OF FAILURE TO COMPLY WITH SAFETY RULES, OR INCORRECT USE.

! WARNING

BERETTA ASSUMES NO LIABILITY FOR ANY INJURY OR DAMAGE TO PROPERTY RESULTING FROM IMPROPER OR CARELESS HANDLING, OR INTENTIONAL OR ACCIDENTAL FIRING OF THE SHOTGUN.

! WARNING

ALL ASSEMBLY, DISASSEMBLY AND MAINTENANCE PROCEDURES MUST BE CARRIED OUT WITH THE FIREARM UNLOADED (CARTRIDGE CHAMBER, RECEIVER AND MAGAZINE EMPTY).

! WARNING

DURING ASSEMBLY, DISASSEMBLY AND MAINTENANCE PROCEDURES, NEVER POINT A FIREARM AT SOMEONE OR AT HARD OR FLAT SURFACES. ALWAYS TREAT A FIREARM AS IF IT WERE LOADED SEE POINTS 1, 2 AND 4 OF THE "BASIC SAFETY RULES".

NOTE: The oil that is on your firearm when you receive it is a preservative oil and not a lubricant. In order to ensure reliable operation, you should clean and lubricate your firearm as outlined in "Routine Maintenance" page 28.

Mount the barrel onto the stock-receiver-forend assembly as described below:

i Notice

It is advisable to carry out the assembly operations over a table to catch components should they drop.

! CAUTION

In the unlikely event that the breech bolt assembly is in the unlocked (OPEN) position, do not press the release button and keep your finger away from the ejection port.

When the bolt release button is pressed, the breech bolt is pushed forward by the recoil spring until it is stopped at the ejection port by the cocking handle, with the likelihood of damage to both parts.

Check the barrel. The barrel and cartridge chamber must be clean and free from obstructions. See "Obstruction Check" page 13.

Check that the choke tube is inserted in the barrel and tightened correctly, clean and in good condition. See "Installation of Choke Tube" page 32 and "Checking the Condition of the Choke Tubes" page 17.

Unscrew the front cap of the forend in a counterclockwise direction and completely remove it.

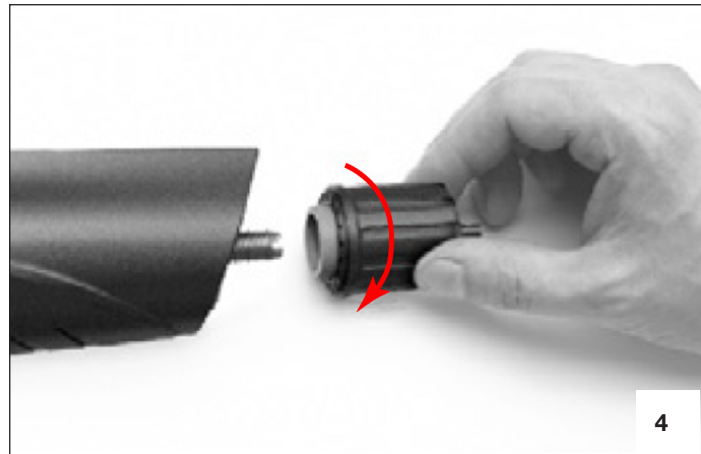

Pull the forend away from the receiver.

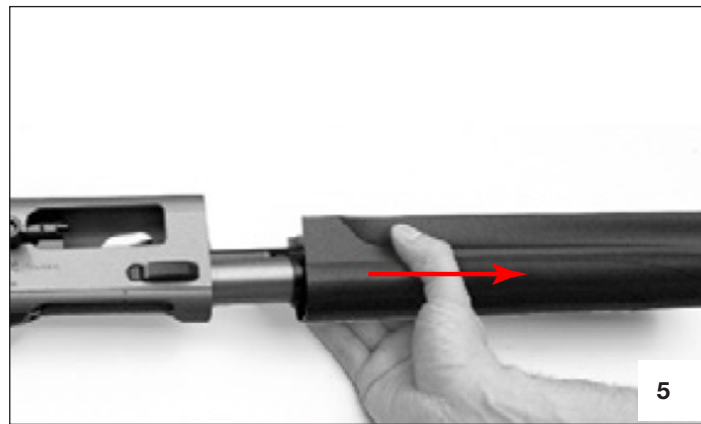

Check that the piston is positioned inside the gas cylinder of the barrel.

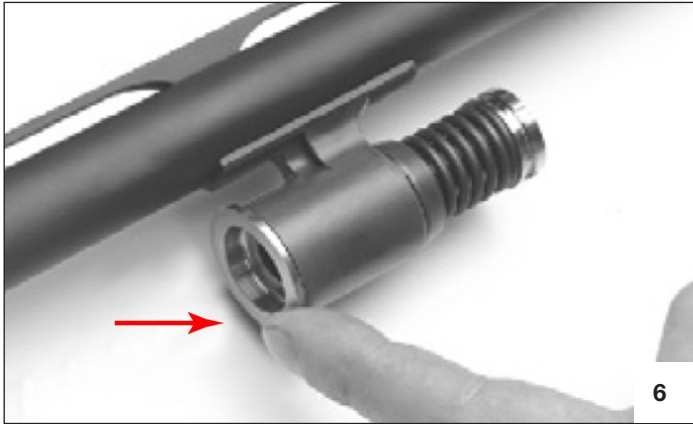

If the piston is mounted on the magazine tube shaft, remove it and insert it into the cylinder of the barrel, making sure to tighten the elastic seal with your fingers to facilitate insertion of the piston into the cylinder.



CAUTION

In order to prevent damage to the elastic piston seal, pinch the piston ring with your fingers to make sure the edges do not twist or bind while inserting. When pinched, the two ends of the piston ring should touch evenly forming a continuous circle. Then insert the piston into the gas cylinder of the barrel.

When pinched, the two ends of the piston ring should touch evenly forming a continuous circle.

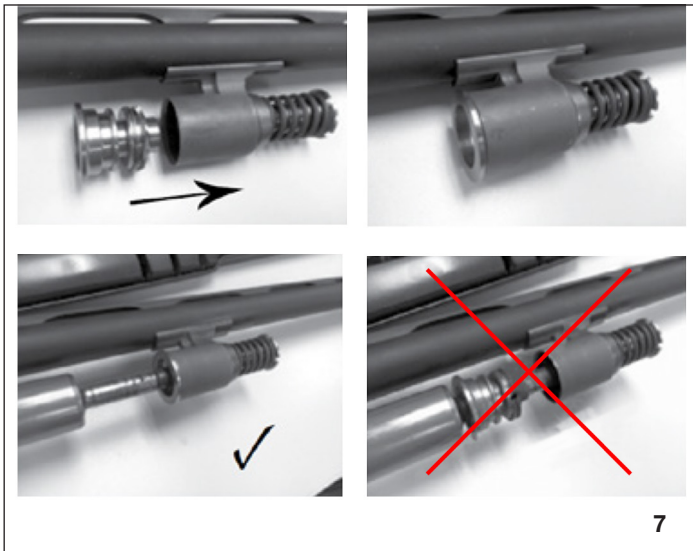

Check that the carrier stop push button is pressed all the way down; otherwise, push it down.



Use the cocking handle to retract the breech bolt until it snaps into the unlocked position.

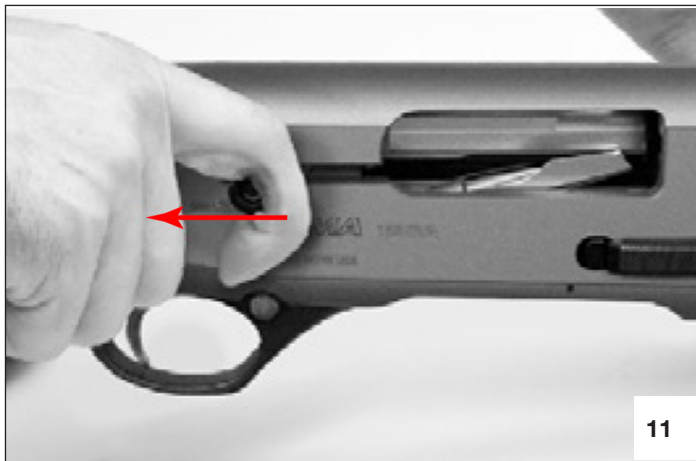

Push the barrel all the way into the receiver until it stops.

Slide the forend into place over the gas cylinder/the valve assembly and magazine tube, checking for the correct centering on the receiver face. The forend is in the correct position when it is fully against the receiver.

CAUTION

When the release button is pressed, the breech bolt is pushed forward by the recoil spring until it is stopped at the ejection port by the cocking handle, with the likelihood of damage to both parts.

Insert the barrel into the receiver, ensuring that the magazine tube shaft enters the piston hole as well as the gas cylinder hole with the valve assembly. See Figures "12" through "14".



Tighten the front cap of the forend all the way.



Keeping your fingers away from the ejection port, press the breech bolt release button and gently guide the breech bolt to the lock position.

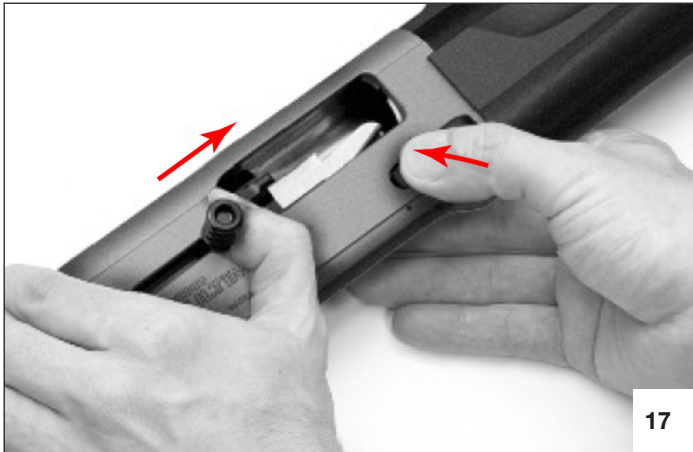

DROP AND CAST SPACERS

Between the stock and the receiver is a technopolymer spacer, and inside the stock is a stainless steel plate that can be used to change the drop and cast of the stock by simply modifying the assembly configuration. The desired configuration can be set by installing the spacers so that they are readable from the “shooter” position. “DX” indicates right handed cast, while “SX” indicates left-handed cast. The letters as well as the numbers corresponding to drop must always match.

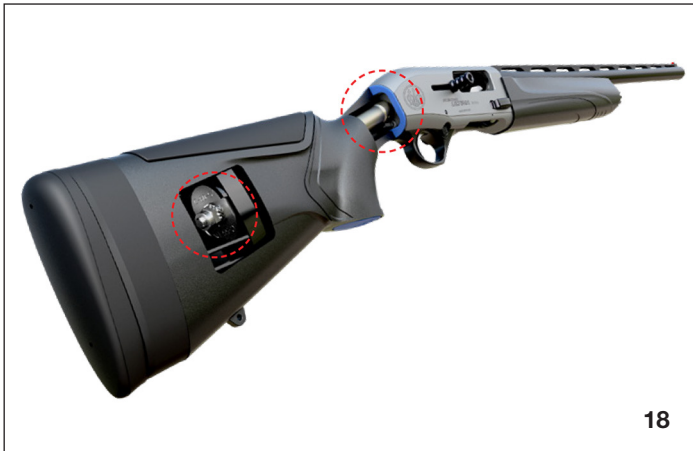

CHECKING THE CONDITION OF THE CHOKE TUBES

CAUTION

Only use Beretta Mobilchoke® choke tubes. Use of improper chokes will cause barrel damage!

- Remove the choke tube from the barrel. See “Removal of Choke Tube” page 23 for more information.
- Always check the appearance and cleaning of the choke tubes before using the shotgun, making sure chokes are properly oiled before installation.
- Check correct tightness in the barrel with the wrench provided.
- Never use choke tubes that show signs of defects, warping or incrustation.
- Make sure that the choke tube inserted is appropriate for the intended use and shot type to be used (steel or lead). See “Ammunition” page 19 for more information.

LOAD CHECK

At various points in this manual, you will be requested to inspect the ejection port, the loading gate, and the cartridge chamber of your firearm to ensure that it is unloaded. This should become second nature to you, as should the following precautions:

- Never assume that the gun is unloaded.
- Never point or push the gun toward yourself or another person.
- Always inspect the ejection port, the loading gate and the cartridge chamber to make sure they are empty with a visual and manual check. The cartridge chamber is the portion of the barrel into which the cartridge is inserted.
- Pull back the breech bolt to lock it into the open position and engage the safety before handing the shotgun to another person. See “Safety Engaged” page 18 for more information.



- Never take from or give the shotgun to another person unless the breech bolt has been opened and locked back, and the ejection port, loading gate and cartridge chamber have been inspected to ensure they are completely empty.

Inspect the ejection port, loading gate and cartridge chamber as indicated below:

! WARNING

KEEP YOUR FINGERS AWAY FROM THE TRIGGER, TURN THE FIREARM IN A SAFE DIRECTION AND ALWAYS ENGAGE THE SAFETY. SEE "SAFETY" PAGE 18 FOR MORE INFORMATION.

Check that the carrier stop push button is pressed all the way down; otherwise, push it down.

- Use the cocking handle to retract the breech bolt until it snaps into the unlocked position.



20

- Engage the manual safety by pressing the safety button to hide the red ring.
- Inspect the firearm by looking through the ejection port, the feeding gate and the cartridge chamber; they must be empty. Check that there are no cartridges in the magazine tube. If there are, unload the firearm as indicated in "How to Unload the Shotgun" page 22.
- Press the breech bolt release button and gently guide it to the locked position.



21

SAFETY

SAFETY DISENGAGED

When the safety button shows the red ring, the SAFETY IS DISENGAGED, and the firearm is ready for use.



22

SAFETY ENGAGED

When the red ring is not visible on the safety button, the SAFETY IS ENGAGED.



23

AMMUNITION

WARNING

BERETTA ASSUMES NO LIABILITY FOR PHYSICAL INJURY OR PROPERTY DAMAGE RESULTING FROM THE USE OF DEFECTIVE, IMPROPER, HAND-LOADED, RELOADED OR REMANUFACTURED AMMUNITION. SERIOUS DAMAGE OR INJURY, EVEN DEATH, MAY BE CAUSED FROM THE USE OF AMMUNITION THAT IS NOT SUITABLE, LOADED WITH FORCE, OR LOADED WITH OBSTRUCTIONS IN THE BARREL.

The shotgun does not require adjustments or interventions to shoot from 70 mm (2 3/4") /24 g (7/8 oz) to 76 mm (3") /57 g (2 oz) cartridges.

CAUTION

The Beretta semi-automatic A300 Ultima has a Mobilchoke® barrel and Mobilchoke® choke tubes that make it possible to fire steel shot ammunition (High Performance included). Follow the instructions for use of choke tubes appropriate for the use of steel shot, as set out in "Steel Shot" page 19.

You will find the markings for the gauge and chamber length for your shotgun on the side of the barrel.

CAUTION

Never use cartridges that do not correspond to the indications on the barrel.

CAUTION

Only use cartridges with a length equal to or less than the chamber length indicated on the barrel.

CAUTION

To avoid using improper ammunition, always check the characteristics stamped on the cartridge box and on the cartridge. Be sure to use the right cartridge gauge and length for your firearm.

CAUTION

Beretta recommends patterning and targeting any regularly used ammo/choke combinations to understand what works best for your barrel.

CAUTION

Firing slugs and buck shot through the A300 Patrol can result in lead buildup in the gas operating system. We recommend cleaning the gas cylinder, piston, ring, and barrel after every 200 rounds to ensure reliable function when firing these types of ammunition. See "Routine Maintenance" page 28 for more information.

STEEL SHOT

All Beretta barrels, as well as the "SP" (Steel Proof) Beretta choke tubes, are designed for use with factory steel shot cartridges loaded to international standard specifications. When steel shot cartridges are fired, the best results are obtained by using open chokes (C****/CL, ****/IC, ***/M). Full choke constrictions (*F, **/M) when using steel shot, do not increase pattern density and will distort normal pattern density, accelerating wear and tear. The use of reloaded or remanufactured ammunition can increase the likelihood of excessive pressure, case rupture or other defects in the ammunition.

MAGAZINE CAPACITY

The magazine of the A300 Ultima has a capacity limited to 2 shots, in line with the current hunting regulations in many countries, due to the insertion of a reducer. This reducer restricts firearm use to no more than three shots (two in the magazine, and one in the cartridge chamber).

Magazine capacity in the A300 Ultima Patrol differs. See "A300 Patrol" page 10 for more information.

CAUTION

Wholesalers, dealers or gunsmiths are not authorized to carry out any Warranty repair or adjustment on behalf of the Manufacturer (unless they are a Repair Point authorized by the Manufacturer and/or by its Local Official Distributors).

WARNING

KEEP YOUR FINGERS AWAY FROM THE TRIGGER, TURN THE FIREARM IN A SAFE DIRECTION AND ALWAYS ENGAGE THE SAFETY. SEE "SAFETY" PAGE 18 FOR MORE INFORMATION.

USING YOUR FIREARM

! WARNING

BERETTA ASSUMES NO LIABILITY FOR PHYSICAL INJURY OR PROPERTY DAMAGE RESULTING FROM THE USE OF DEFECTIVE, IMPROPER, HAND-LOADED, RELOADED OR REMANUFACTURED AMMUNITION. SERIOUS DAMAGE OR INJURY, EVEN DEATH, MAY BE CAUSED FROM THE USE OF AMMUNITION THAT IS NOT SUITABLE, LOADED WITH FORCE, OR LOADED WITH OBSTRUCTIONS IN THE BARREL. THE USE OF RELOADED AMMUNITION WILL VOID THE MANUFACTURER'S WARRANTY. ONLY USE TOP-QUALITY, FACTORY- LOADED AMMUNITION.

! WARNING

TO AVOID FIREARM MALFUNCTIONS, INSPECT EACH CARTRIDGE BEFORE INSERTING IT INTO THE CHAMBER OR MAGAZINE. MAKE SURE THAT THE CARTRIDGE HEADS ARE NOT DAMAGED OR DEFORMED AND THAT THE CARTRIDGES HAVE NO OTHER TYPE OF DENT OR DEFECT (THESE CHECKS MUST ALSO BE MADE FOR FACTORY-NEW AMMUNITION).

HOW TO LOAD AND FIRE

! WARNING

BEFORE LOADING THE FIREARM, IT IS A GOOD IDEA TO PRACTICE THE FOLLOWING HANDLING PROCEDURES WITHOUT THE USE OF AMMUNITION. NEVER HANDLE A LOADED FIREARM UNTIL YOU ARE FULLY FAMILIAR WITH THE LOADING PROCEDURES. ALWAYS INSPECT THE EJECTION PORT, THE LOADING GATE AND THE CARTRIDGE CHAMBER TO MAKE SURE THEY ARE EMPTY. CHECK THAT THERE ARE NO CARTRIDGES IN THE MAGAZINE TUBE. BEFORE LOADING THE FIREARM, ENSURE THAT THE SAFETY IS ENGAGED. ALWAYS KEEP THE FIREARM POINTED IN A SAFE DIRECTION. SEE POINTS 1, 2 AND 4 OF THE "BASIC SAFETY RULES" PAGE 3 FOR MORE INFORMATION.

! WARNING

ALWAYS CHECK THE BARREL BEFORE LOADING THE FIREARM TO MAKE SURE THAT IT IS CLEAN AND FREE OF POSSIBLE OBSTRUCTIONS. SEE "OBSTRUCTION CHECK" PAGE 13 FOR MORE INFORMATION. SEE "BASIC SAFETY RULES" PAGE 3 FOR MORE INFORMATION.

! WARNING

CHECK THE CONDITIONS AND CORRECT TIGHTNESS OF THE CHOKE TUBE IN THE BARREL. NEVER USE THE SHOTGUN WITHOUT THE CHOKE TUBE INSERTED. SEE "CHECKING THE CONDITION OF THE CHOKE TUBES" PAGE 17 FOR MORE INFORMATION.

! WARNING

THE SHOOTER AND ALL BYSTANDERS MUST ALWAYS WEAR PROTECTIVE EYEWEAR AND EAR PROTECTION DURING SHOOTING. RESIDUE FROM GUNPOWDER, LUBRICANT OR METAL FRAGMENTS MAY BE PROJECTED BACKWARDS AND CAUSE INJURY. NOISE-REDUCING EARPLUGS OR EARMUFFS WILL REDUCE THE RISK OF DAMAGE TO HEARING CAUSED BY PROLONGED SHOOTING ACTIVITY.

! WARNING

ALWAYS KEEP YOUR FINGER OFF THE TRIGGER AND AVOID CONTACT OF OTHER OBJECTS WITH THE TRIGGER IF YOU DON'T INTEND TO FIRE.

Check that the carrier stop push button is pressed all the way down; otherwise, push it down.



Use the cocking handle to retract the breech bolt until it snaps into the open position.

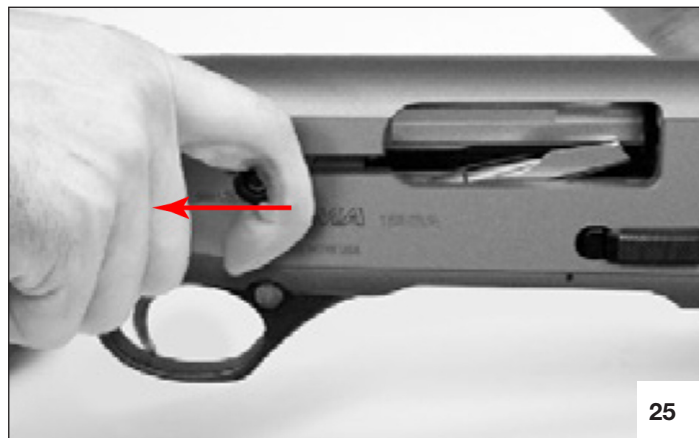

Engage the manual safety by pressing the safety button to hide the red ring.



! WARNING

THE FIREARM IS NOW LOADED AND READY TO FIRE AFTER THE MANUAL SAFETY IS DISENGAGED. ALWAYS KEEP YOUR FINGER OFF THE TRIGGER AND AVOID CONTACT WITH THE TRIGGER BY OTHER OBJECTS IF YOU DON'T INTEND TO FIRE. NEVER POINT A FIREARM AT SOMETHING THAT IS NOT SAFE TO SHOOT. SEE POINTS 1, 2 AND 4 OF "BASIC SAFETY RULES" PAGE 3 FOR MORE INFORMATION.

! WARNING

BERETTA ASSUMES NO LIABILITY FOR ANY INJURY OR PROPERTY DAMAGE RESULTING FROM IMPROPER OR CARELESS HANDLING OR INTENTIONAL OR ACCIDENTAL FIRING OF THE SHOTGUN.

! WARNING

THE MANUAL SAFETY IS MERELY A MECHANICAL DEVICE AND IS IN NO WAY A SUBSTITUTE FOR THE BASIC SAFETY RULES OF FIREARM HANDLING.

Introduce the first cartridge into the cartridge chamber through the ejection port.



Move the carrier to insert the cartridges into the magazine through the loading gate to hook onto the cartridge latch.



To fire, disengage the safety (red ring visible) and pull the trigger.

Keeping your hands away from the ejection port, press the breech bolt release button and guide the breech bolt to the locked position.



After firing the first shot, release the trigger to set up the shotgun for the next round.

The shotgun will fire the cartridge in the chamber first, and then it will automatically load the cartridge from the magazine tube into the chamber.

! WARNING

AFTER PULLING THE TRIGGER, IF THE SHOTGUN DOESN'T FIRE, KEEP THE GUN POINTED IN A SAFE DIRECTION, ENGAGE THE SAFETY IF POSSIBLE, WAIT AT LEAST 1 MINUTE AND UNLOAD THE SHOTGUN AS DESCRIBED IN THE CORRESPONDING SECTION.

Never attempt to reuse or fire ammunition that did not fire the first time. Dispose of unfired or damaged ammunition properly, in accordance with the ammunition manufacturer's recommendations.

! WARNING

IF ANOTHER CARTRIDGE IS FIRED INTO AN OBSTRUCTED BARREL, DAMAGE AND VERY SERIOUS INJURY MAY OCCUR.

If you do not plan to fire a second shot, engage the safety (red ring not visible) keeping the firearm pointed in a safe direction and the fingers away from the trigger. If you have finished firing, unload the shotgun as indicated. See "How to Unload the Shotgun" page 22 for more information.

When the last cartridge has been fired, the breech bolt remains open, showing that the magazine is empty.



Engage the safety (red ring not visible), and if necessary, reload the shotgun according to the previous instructions.



! WARNING

ALWAYS UNLOAD THE FIREARM IMMEDIATELY AFTER FIRING IS COMPLETED. NEVER STORE A LOADED FIREARM. TO STORE THE SHOTGUN, SEE "HOW TO UNLOAD THE SHOTGUN" PAGE 22 AND "STORAGE" PAGE 35 FOR MORE INFORMATION.

HOW TO UNLOAD THE SHOTGUN

! WARNING

WHEN THE FIREARM IS LOADED AND READY TO FIRE, ALWAYS KEEP YOUR FINGER OFF THE TRIGGER AND AVOID CONTACT WITH THE TRIGGER BY OTHER OBJECTS. IF YOU DON'T INTEND TO FIRE, NEVER POINT THE FIREARM AT SOMEONE OR AT HARD, FLAT SURFACES.

While keeping the firearm pointed in a safe direction, check that the safety is engaged (red ring not visible).



Pull back the breech bolt to extract and expel the live cartridge from the chamber.



Keeping your fingers away from the ejection port, gently release the breech bolt so that it locks.

Raise the carrier and push the cartridge, which is visible in the magazine tube, lightly into the magazine tube to release pressure from the shell catch lever and at the same time press down the release button (shell catch lever), guiding the cartridges out of the magazine tube.

After checking that the magazine tube and the receiver are empty, keep the shotgun pointed in a safe direction and disengage the safety (red ring visible).



A300 ULTIMA DISASSEMBLY

WARNING

ALWAYS CHECK THAT THE SHOTGUN IS UNLOADED (EMPTY CARTRIDGE CHAMBER, EMPTY RECEIVER, EMPTY MAGAZINE). INSPECT THE FIREARM BY LOOKING THROUGH THE EJECTION PORT, THE LOADING GATE AND THE CHAMBER. IF IT IS NOT EMPTY, UNLOAD IT AS INSTRUCTED IN THE RELEVANT SECTION. CHECK THAT THE HAMMER IS DECOCKED.

WARNING

NEVER POINT THE FIREARM AT SOMEONE OR AT HARD, FLAT SURFACES. ALWAYS TREAT THE SHOTGUN AS IF IT WERE LOADED. SEE POINTS 1, 2 AND 4 OF "BASIC SAFETY RULES" PAGE 3 FOR MORE INFORMATION.

Notice

It is advisable to carry out the disassembly operations over a table to catch components should they drop.

REMOVAL OF CHOKE TUBE

WARNING

ALWAYS CHECK THAT THE SHOTGUN IS UNLOADED (EMPTY CARTRIDGE CHAMBER, EMPTY RECEIVER, EMPTY MAGAZINE). INSPECT THE FIREARM BY LOOKING THROUGH THE EJECTION PORT, THE LOADING GATE AND THE CHAMBER. IF IT IS NOT EMPTY, UNLOAD IT AS INSTRUCTED IN THE RELEVANT SECTION.

WARNING

NEVER LOOK DIRECTLY THROUGH THE BARREL FROM THE MUZZLE AND DO NOT REPLACE THE CHOKE WITH THE SHOTGUN LOADED EVEN WITH THE SAFETY ENGAGED.

Unscrew the choke tube in a counterclockwise direction with the wrench provided.

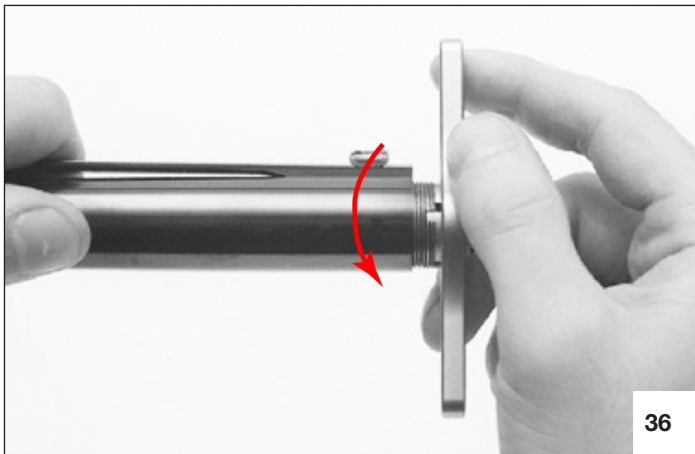

Remove the choke tube from the muzzle of the barrel.

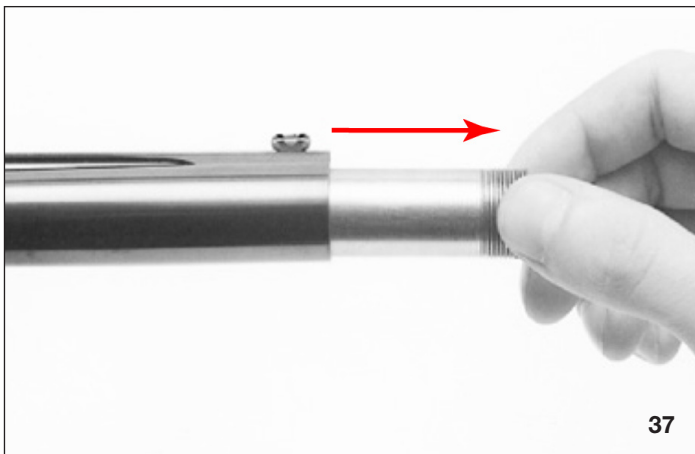

REMOVAL OF BARREL

Check that the carrier stop push button is pressed all the way down. If it is not, push it all the way down.



Pull the breech bolt all the way back so that it remains open.



Unscrew the front cap of forend in a counterclockwise direction.



Holding the shotgun by the barrel, pull the forend straight out toward the muzzle.

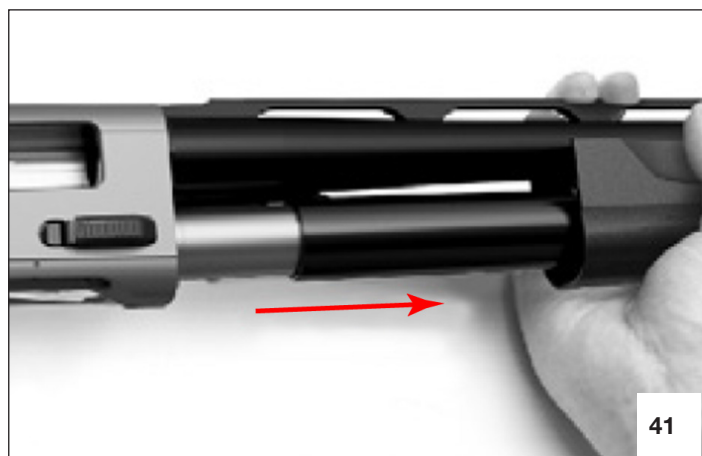

Pull the barrel out of the stock-receiver assembly while holding the piston inside the gas cylinder of the barrel.



Pulling forcefully, extract the cocking handle from the breech bolt.



CAUTION

NEVER REMOVE the spring of the valve or the valve retaining nut. The valve device is self-cleaning and requires no maintenance. If necessary, contact a competent gunsmith.

REMOVAL OF BREECH BOLT ASSEMBLY

Notice

The breech bolt assembly only needs to be disassembled in order to clean its components.

Remove the barrel. See “Removal of Barrel” page 24 for more information.

Press the breech bolt release button and gently guide the breech bolt to the locked position.



Over a flat surface, with the ejection port pointed upwards, slide the connecting rod with sleeve forward off the magazine tube shaft to extract the breech bolt assembly from the receiver.



The breech bolt assembly, no longer held by the connecting rod with sleeve, will divide into:

- Breech bolt with firing pin, locking block, extractor, springs and pins.
- Sleeve with connecting rod.



REMOVAL OF TRIGGER PACK

Notice

The trigger pack only needs to be disassembled in order to clean the trigger mechanism.

With the hammer cocked, engage the safety (red ring not visible).



Press the carrier stop push button, if it has not already been pressed.



Remove the trigger guard retaining pin by pressing with a pin punch or an awl.

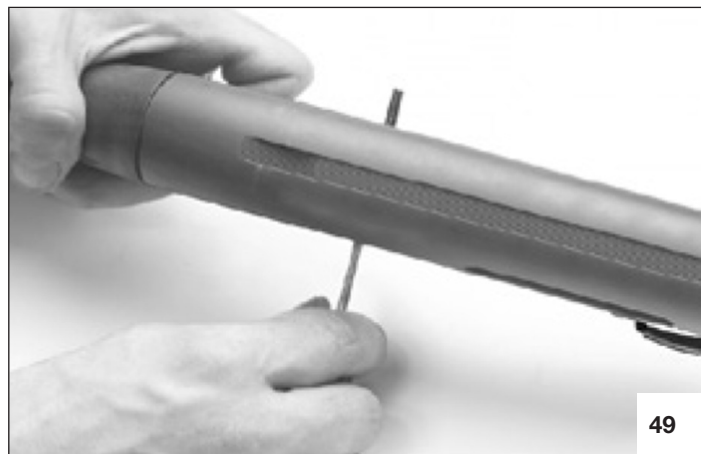

Keeping the breech bolt release button pushed all the way down, remove the trigger plate from the receiver using the trigger guard as a lever, first in the direction of the barrel and then outward.



A300 PATROL DISASSEMBLY

Check to be sure the firearm is unloaded. See “How to Unload the Shotgun” page 22 for more information.

Press the carrier stop push button, if it has not already been pressed.



Lock the bolt to the rear.



Remove the barrel to mag tube clamp by loosening the (2) hex screws.



Unscrew and remove the mag tube cap.



Slide the forend towards the muzzle.

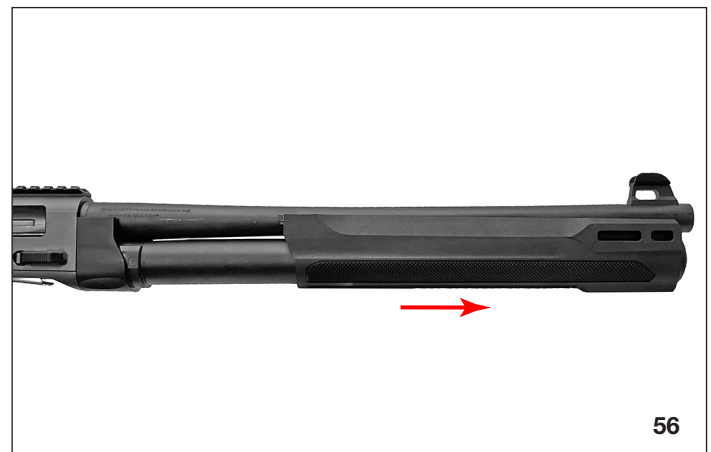

Remove the barrel assembly from the receiver.

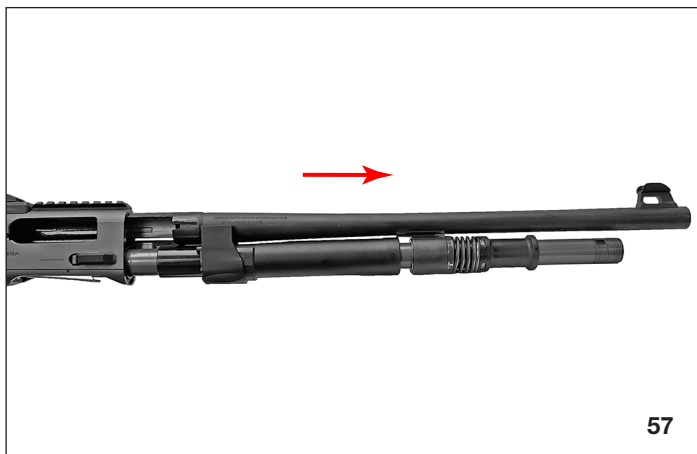

With the barrel assembly off the forend adapter/piston stop can now be removed.

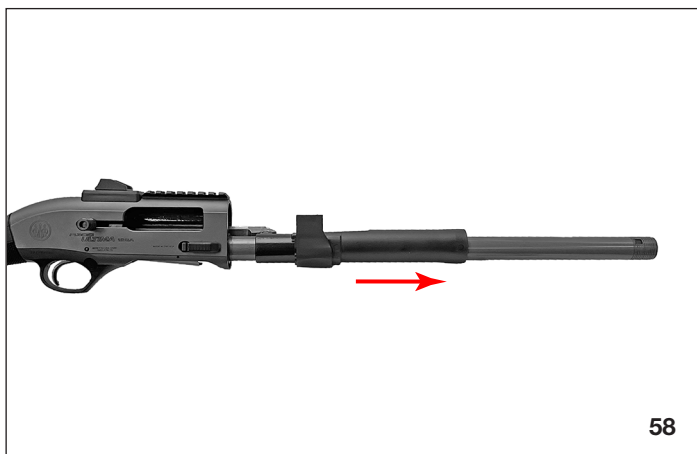

ROUTINE MAINTENANCE

Clean and lubricate your shotgun any time combustion residue, grease or dirt is deposited in any of the mechanisms. Cleaning and lubrication of the firearm after each use is the best way of ensuring that the components are protected against combustion corrosion or rusting from use in humid or salty environments.

At the end of a shooting day, carry out the Routine Maintenance as indicated below:

! WARNING

ALWAYS CHECK THAT THE SHOTGUN IS UNLOADED (EMPTY CARTRIDGE CHAMBER, EMPTY RECEIVER, EMPTY MAGAZINE). INSPECT THE FIREARM BY LOOKING THROUGH THE EJECTION PORT, THE LOADING GATE AND THE CHAMBER. IF IT IS NOT EMPTY, UNLOAD IT AS INSTRUCTED IN THE RELEVANT SECTION.

! WARNING

NEVER POINT THE FIREARM AT SOMEONE OR AT HARD, FLAT SURFACES. ALWAYS TREAT THE SHOTGUN AS IF IT WERE LOADED. SEE POINTS 1, 2 AND 4 OF "BASIC SAFETY RULES" PAGE 3 FOR MORE INFORMATION.

i Notice

For Routine Maintenance, simply disassemble the shotgun following the procedures described in the relevant section.

CLEANING OF CHOKE TUBE AND CHOKE TUBE HOUSING

! WARNING

ALWAYS CHECK THAT THE SHOTGUN IS UNLOADED (EMPTY CARTRIDGE CHAMBER, EMPTY RECEIVER, EMPTY MAGAZINE). INSPECT THE FIREARM BY LOOKING THROUGH THE EJECTION PORT, THE LOADING GATE AND THE CHAMBER. IF IT IS NOT EMPTY, UNLOAD IT AS INSTRUCTED IN THE RELEVANT SECTION.

! WARNING

NEVER LOOK DIRECTLY THROUGH THE BARREL FROM THE MUZZLE, AND DO NOT REPLACE THE CHOKE WITH THE SHOTGUN LOADED, EVEN WITH THE SAFETY ENGAGED.

Remove the choke tube. See "Removal of Choke Tube" page 23 for more information.

Clean the choke housing thoroughly using, if necessary, a brush swab soaked with Beretta Gun Oil. Dry the housing with a soft cloth.

Check that the choke is perfectly clean inside and outside.

Apply a thin film of Beretta Gun Oil on the barrel thread and choke tube.

CLEANING OF BARREL

Remove the barrel. See "Removal of Barrel" page 24 for more information.

Carefully clean the inside of the barrel with a soft cloth patch to remove any combustion residue. If necessary, use a brass brush or a cloth soaked with Beretta Gun Oil.

Thoroughly clean the barrel extension.

Pull a soft, clean, dry cloth patch through the barrel.

Lightly lubricate the barrel with a soft clean cloth soaked with Beretta Gun Oil.

Check the barrel. The barrel and cartridge chamber must be clean and free from obstructions. See "Obstruction Check" page 13 for more information.

CAUTION

Excess oil or grease obstructing the barrel, even partially, is very dangerous when firing and may cause damage to the shotgun and serious injury to the shooter and to bystanders. Never spray or apply oil to the cartridges. Use lubricants properly. You are responsible for the proper care and maintenance of your firearm.

CLEANING OF GAS CYLINDER, PISTON, MAGAZINE TUBE

Remove the barrel. See "Removal of Barrel" page 24 for more information.

Spray the magazine tube shaft and clean with Beretta Gun Oil.

Make sure that the piston glides freely on the magazine tube shaft.

To clean the walls of the gas cylinder, clean thoroughly with a brass brush.

After removing any combustion residue, clean the inside of the gas cylinder with a clean cloth.

Never oil inside the gas cylinder.

Notice

The components specified above must not be lubricated.

CLEANING OF EXHAUST VALVE ASSEMBLY

Notice

NEVER DISASSEMBLE the exhaust valve assembly. If necessary, contact a competent gunsmith.

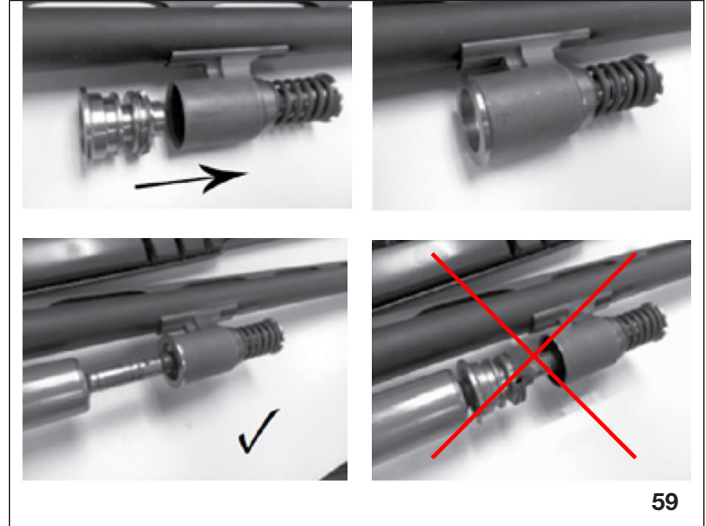

59

RECOMMENDED STORAGE MAINTENANCE

Depending on the conditions of use of the firearm and at the end of the hunting season, Beretta recommends you carry out the following increased maintenance operations in order to keep the shotgun in perfect working order.

CLEANING OF BREECH BOLT ASSEMBLY

Remove the breech bolt assembly. See "Removal of Breech Bolt Assembly" page 25 for more information.

Spray the parts and clean with Beretta Gun Oil.

Thoroughly dry with a soft cloth and lightly lubricate.

CLEANING OF TRIGGER PACK

Remove the trigger pack. See "Removal of Trigger Pack" page 26 for more information.

Thoroughly clean the parts with a soft cloth.

Lightly lubricate all the metal components and the trigger plate retaining pin.

CLEANING OF RECEIVER

Proceed as indicated for the breech bolt. Clean thoroughly with a soft cloth and lubricate the internal breech bolt guides.

CAUTION

Do not attempt to carry out repairs to any firearm without proper knowledge or training. Do not alter parts or use substitute parts not manufactured by Beretta. Any alterations or adjustments that may be necessary to the operating mechanism should be performed by the Manufacturer or by its Local Authorized Distributor.

A300 ULTIMA REASSEMBLY

WARNING

ALWAYS CHECK THAT THE SHOTGUN IS UNLOADED (EMPTY CARTRIDGE CHAMBER, EMPTY RECEIVER, EMPTY MAGAZINE). INSPECT THE FIREARM BY LOOKING THROUGH THE EJECTION PORT, THE LOADING GATE AND THE CHAMBER. IF IT IS NOT EMPTY, UNLOAD IT AS INSTRUCTED IN THE RELEVANT SECTION.

WARNING

NEVER POINT THE FIREARM AT SOMEONE OR AT HARD, FLAT SURFACES. ALWAYS TREAT THE SHOTGUN AS IF IT WERE LOADED. SEE POINTS 1, 2 AND 4 OF "BASIC SAFETY RULES" PAGE 3 FOR MORE INFORMATION.

INSTALLATION OF TRIGGER PACK

Work in reverse order of disassembly, see "Removal of Trigger Pack" page 26. Take care to ensure that the hammer is cocked, the safety is engaged and the carrier stop push button is pressed down.

Keeping the release button pressed down, align the rear part of the trigger pack precisely to the receiver and push firmly towards the stock as far as it will go.

Rotate the trigger pack until it is inserted in its housing in the receiver.

Insert the trigger guard retaining pin only when the hole of the trigger guard is centered on the receiver.

INSTALLATION OF BREECH BOLT ASSEMBLY

Remount the connecting rod with sleeve on the breech bolt.

Working on a flat surface with the ejection port turned up, mount the breech bolt assembly and the operating rod with sleeve on the magazine tube shaft.

Push the breech bolt operating rod all the way in to insert the breech bolt into the receiver.

Slide the breech bolt operating rod downward, compressing the internal recoil spring until the breech locks into the open position.

Insert the cocking handle on the breech bolt. Fasten it into position by hitting it firmly.

INSTALLATION OF BARREL

Check the barrel for obstructions. The barrel and cartridge chamber must be clean and free from obstructions. See "Obstruction Check" page 13 and "Cleaning of Barrel" page 29 for more information.

Insert the piston into the gas cylinder of the barrel, tightening the elastic seal with your fingers to make it easier to install the piston in the cylinder.

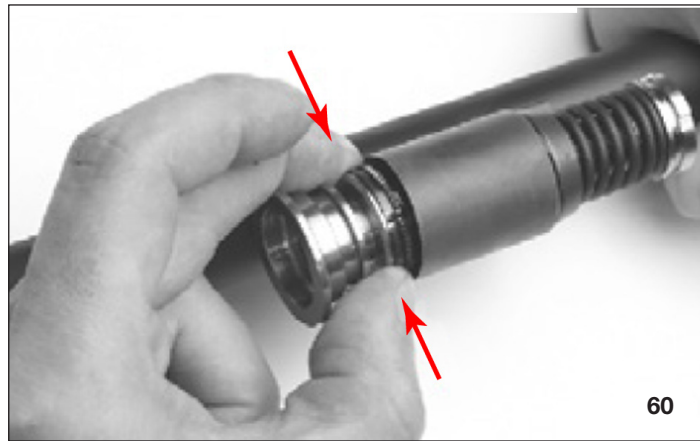

Check that the carrier stop push button is pressed all the way down. If it is not, push it all the way down.



Pull the breech bolt all the way back so that it remains open.



Push the barrel all the way into the receiver until it stops.



CAUTION

When the release button is pressed, the breech bolt is pushed forward by the recoil spring until it is stopped at the ejection port by the cocking handle, with the likelihood of damage to both parts.

Insert the barrel into the receiver, ensuring that the magazine tube shaft enters the piston hole as well as that of the gas cylinder and the valve assembly.



Slide the forend into place over the gas cylinder/the valve assembly and magazine tube, checking for the correct centering on the receiver face. The forend is in the correct position when it is fully against the receiver.



Screw the forend cap on tightly.



Keeping your fingers away from the ejection port, press the breech bolt release button and gently guide the breech bolt to lock.

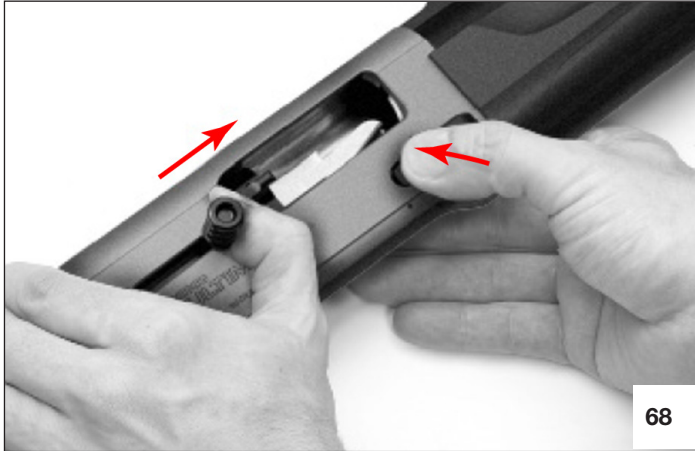

! WARNING

STORE YOUR FIREARM SO THAT CHILDREN OR OTHER PERSONS NOT FAMILIAR WITH FIREARMS CANNOT GAIN ACCESS TO IT. TO REDUCE THE RISK OF ACCIDENTS INVOLVING CHILDREN, UNLOAD YOUR FIREARM AND LOCK IT AWAY. STORE THE AMMUNITION IN A SEPARATE LOCKED LOCATION. SEE POINT 3 OF "BASIC SAFETY RULES" PAGE 3 FOR MORE INFORMATION.

i Notice

If the firearm will not be used for a long time, keep it lubricated and disassembled. See "Recommended Storage Maintenance" page 29 and "Storage" page 35 for more information.

INSTALLATION OF CHOKE TUBE

! CAUTION

Always check that the shotgun is unloaded (empty cartridge chamber, empty receiver, empty magazine). Inspect the firearm by looking through the ejection port, the loading gate and the chamber. If it is not empty, unload it as instructed in the relevant section. Check that the hammer is decocked.

! CAUTION

Check that the choke tube is in pristine condition (not damaged) prior to installing it.

Make sure that the barrel thread and choke tube are perfectly clean and lightly oiled.

Install the desired choke tube.

Manually screw the choke tube clockwise into the barrel. Use the Beretta wrench provided to tighten the choke tube until it is fully lowered into its seat in the barrel. Forcefully tighten the choke tube manually.

Remove the wrench from the barrel.

! CAUTION

Periodically check that the choke tube is tightened correctly, ensuring that the shotgun is unloaded (empty cartridge chamber, empty receiver and empty magazine) and breech bolt is in the open position. If necessary, firmly tighten the choke tube with the Beretta choke wrench. Correct tightening of the choke tube will avoid the occurrence of shotgun damage or injury.

! CAUTION

The choke must be kept correctly tightened in the barrel at all times, even during storage and cleaning. Cleaning the barrel without the choke tube installed may lead to dirt becoming lodged in the barrel thread and prevent the choke tube from screwing in properly, or cause formation of rust or obstruction in the barrel.

! WARNING

NEVER SHOOT THE CHOKE BARREL WITHOUT INSERTING A CHOKE TUBE. SHOOTING WITHOUT A CHOKE TUBE IN THE BARREL IS VERY DANGEROUS, AS RESIDUES OF LEAD OR DEBRIS MAY BECOME LODGED IN THE THREAD CREATING AN OBSTRUCTION WITHIN THE BARREL. ALSO, NOT USING A CHOKE TUBE WILL DAMAGE THE THREADING OF THE BARREL IRREPARABLY AND RESULT IN IRREGULAR SHOT SPREAD.

! WARNING

DO NOT ALTER OR MODIFY AN EXISTING FIXED CHOKE BERETTA BARREL FOR THE USE OF INTERCHANGEABLE CHOKE TUBES. THE BARREL WALL THICKNESS WOULD BE TOO THIN TO SAFELY CONTAIN THE PRESSURE LEVELS GENERATED BY SHOOTING.

A300 PATROL REASSEMBLY

Install the forend adapter/piston stop to the extended magazine tube.

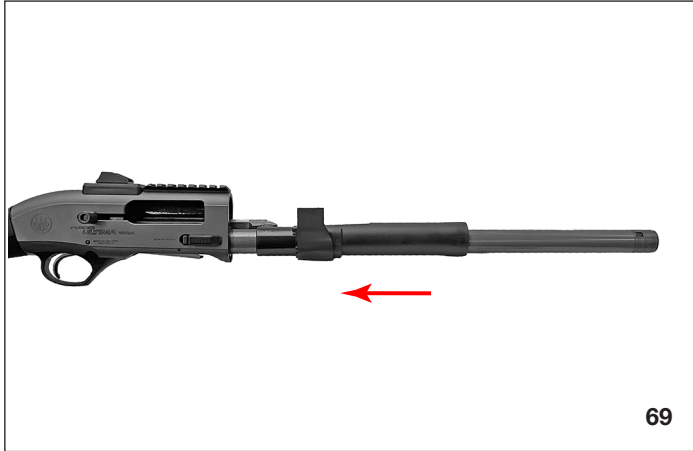

Insert the barrel into the receiver, ensuring that the magazine tube shaft enters the piston hole as well as that of the gas cylinder and the valve assembly.

NOTE: If the barrel tang binds up against the receiver's barrel seat, move the forend adapter/piston stop toward the muzzle, 1 to 2 inches. This will give the barrel tang more room to engage with the receiver's barrel seat.

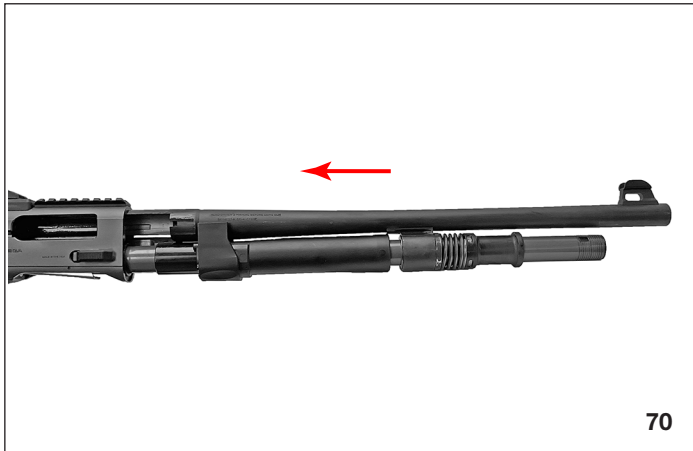

Slide the forend into place over the gas cylinder/the valve assembly and magazine tube checking for the correct centering on the receiver face.

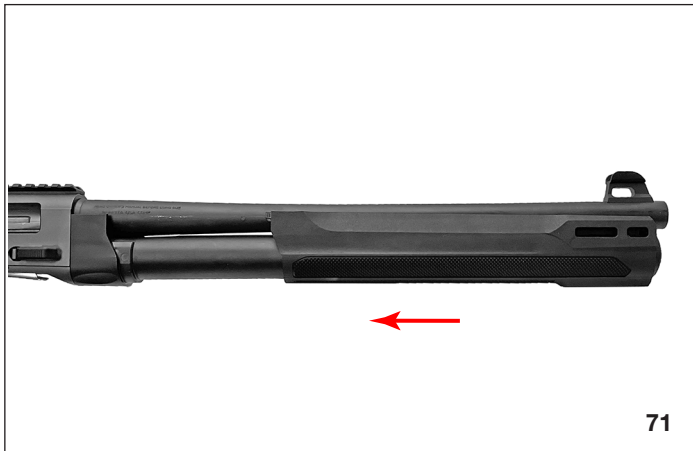

Screw the forend cap on tightly.



Install the barrel to mag tube clamp. Tighten the (2) hex screws securely.



WARNING

STORE YOUR FIREARM SO THAT CHILDREN OR OTHER PERSONS NOT FAMILIAR WITH FIREARMS CANNOT GAIN ACCESS TO IT. TO REDUCE THE RISK OF ACCIDENTS INVOLVING CHILDREN, UNLOAD YOUR FIREARM AND LOCK IT AWAY. STORE THE AMMUNITION IN A SEPARATE LOCKED LOCATION. SEE POINT 3 OF "BASIC SAFETY RULES" PAGE 3 FOR MORE INFORMATION.

Notice

If the firearm will not be used for a long time, keep it lubricated and disassembled. See "Recommended Storage Maintenance" page 29 and "Storage" page 35 for more information.

A300 PATROL TORQUE VALUES

Rear sight base/sight insert	.45-.5 N•m (4-4.5 in/lbs)
Picatinny rail	1.6-1.8 N•m (14-16 in/lb)

STOCK DROP AND CAST MODIFICATION

! WARNING

ALWAYS CHECK THAT THE SHOTGUN IS UNLOADED (EMPTY CARTRIDGE CHAMBER, EMPTY RECEIVER, EMPTY MAGAZINE). INSPECT THE FIREARM BY LOOKING THROUGH THE EJECTION PORT, THE LOADING GATE AND THE CHAMBER. IF IT IS NOT EMPTY, UNLOAD IT. SEE "HOW TO UNLOAD THE SHOTGUN" PAGE 22 FOR MORE INFORMATION.

! WARNING

NEVER POINT THE FIREARM AT SOMEONE OR AT HARD, FLAT SURFACES. ALWAYS TREAT THE SHOTGUN AS IF IT WERE LOADED. SEE "BASIC SAFETY RULES" PAGE 3 FOR MORE INFORMATION.

The Beretta semi-automatic A300 Ultima has a pre-set factory stock cast-off setting (for right-handed shooters) with a 50 or 65 mm drop.

The components which govern the drop and the cast are as follows:

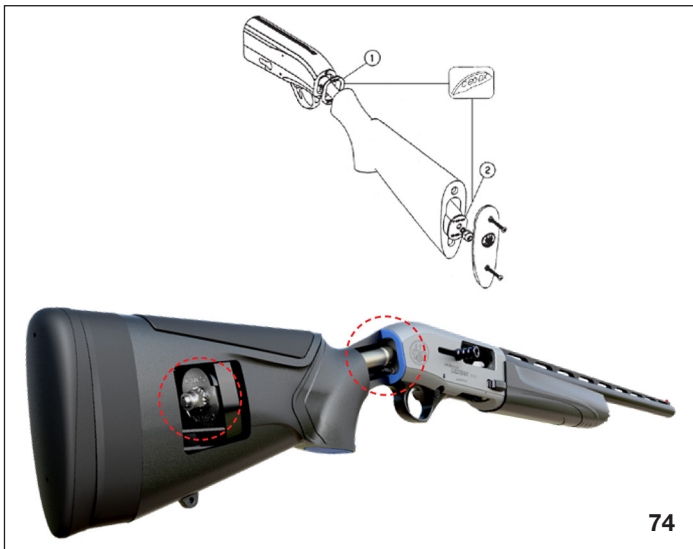

- 1 The drop-cast front spacer, made of reinforced technopolymer fiberglass.
- 2 The stock steel plate.

Both the front spacer (1) and the plate (2) are designed to secure two different drops, each with a cast-off "DX" (for right-handed shooters) or a cast-on "SX" (for left-handed shooters), depending on how they are assembled.

REPLACING THE STOCK DROP AND CAST SPACERS

i Notice

The right-hand cast is designated by the initials DX. The left-hand cast is designated by the initials SX. The drop and cast of the front spacer and plate must always match with the adjustment set from the "shooter" perspective (behind the gun).

! WARNING

STOCK DROP AND CAST MODIFICATION MUST BE CARRIED OUT BY A COMPETENT GUNSMITH. FAILURE TO COMPLY WITH THESE INSTRUCTIONS CAN LEAD TO DAMAGE TO PROPERTY OR INJURY TO PERSONS.

Required Tools

N° 1 Phillips screwdriver

N° 1 Socket wrench, 13 mm with deep well extension

N° 1 Torque wrench (previously mentioned), with a 13-mm pipe extension

FIELD STRIPPING

Use the Phillips screwdriver to remove the two screws sunk into the recoil pad on the stock. A small drop of oil on each hole before you insert the screwdriver will help to reduce tool marks and wear on the recoil pad.

Remove the Beretta recoil pad from the stock.

Using the 13-mm socket wrench, unscrew the retaining nut of the stock and remove the nut and spring washer.

Separate the stock from the receiver and remove the plate (1).

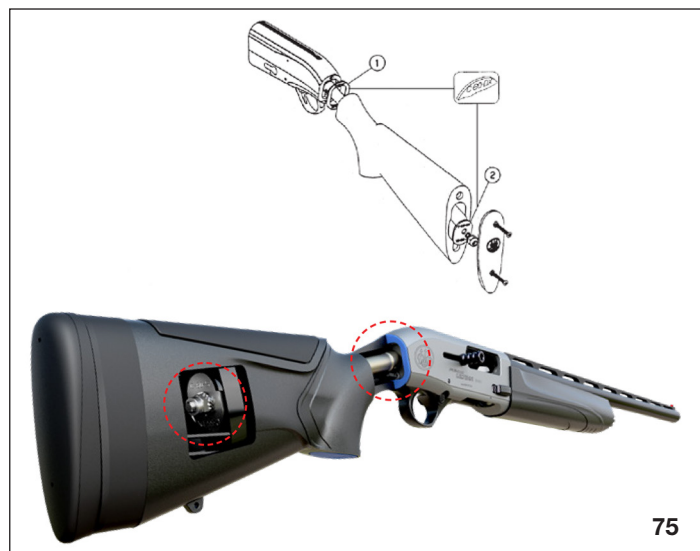

Separate the stock and Kickoff unit.

Remove the drop/cast plate from Kickoff unit and adjust it to the desired orientation.

REASSEMBLY AFTER FIELD STRIPPING

Center the front spacer (1) on the stock bolt tube. Make sure that the indicator showing the desired drop and cast ("C-60-DX" in the diagram) is visible on the top of the spacer.

Place the rear plate (2) inside the Kickoff. Make sure that the same markings are visible on the plates. Install Kickoff into stock.

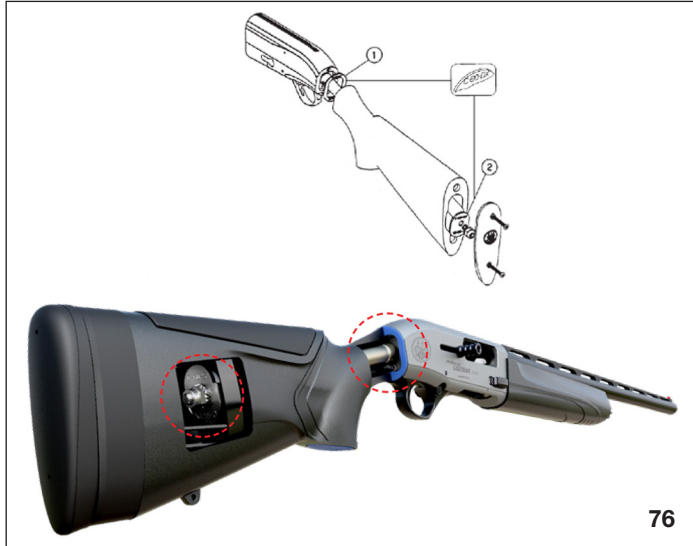

Reposition the stock assembly.

Using the 13-mm socket wrench, insert the retaining nut of the stock and spring washer and tighten down with tightening torque 1.6 – 1.8 Kgm (Kilogrammeters). The use of a proper torque wrench is recommended.

Screw on the recoil pad.

STORAGE

WARNING

TO REDUCE THE RISK OF ACCIDENTS INVOLVING CHILDREN OR UNAUTHORIZED PERSONS, KEEP YOUR FIREARM LOCKED AWAY AND STORE THE AMMUNITION IN A SEPARATE LOCKED LOCATION!

Notice

Store the firearm disassembled (barrel/forend and receiver/stock) in the supplied case. Before storage, always check the condition of the shotgun and its case. Ensure that they are perfectly dry. Moisture and water drops can damage the shotgun.

Notice

Do not store the shotgun in a leather or fabric case. These materials attract moisture, even though they may appear to be perfectly dry.

WARRANTY

The Warranty and extension of the warranty period is packed with your Beretta shotgun. Please refer to the WARRANTY and the related instructions should a repair service be required under the warranty period.

Notice

Wholesalers, dealers or gunsmiths are not authorized to carry out any Warranty repair or adjustment on behalf of the Manufacturer (unless they are a Repair Point authorized by the Manufacturer and/or by its Local Official Distributors).

Notice

The warranty is only valid for the original purchaser.

ACCESSORIES

Please check www.Beretta.com for a comprehensive list of the latest recommended accessories.

A300 PATROL PARTS LIST

A300
ULTIMA
PATROL

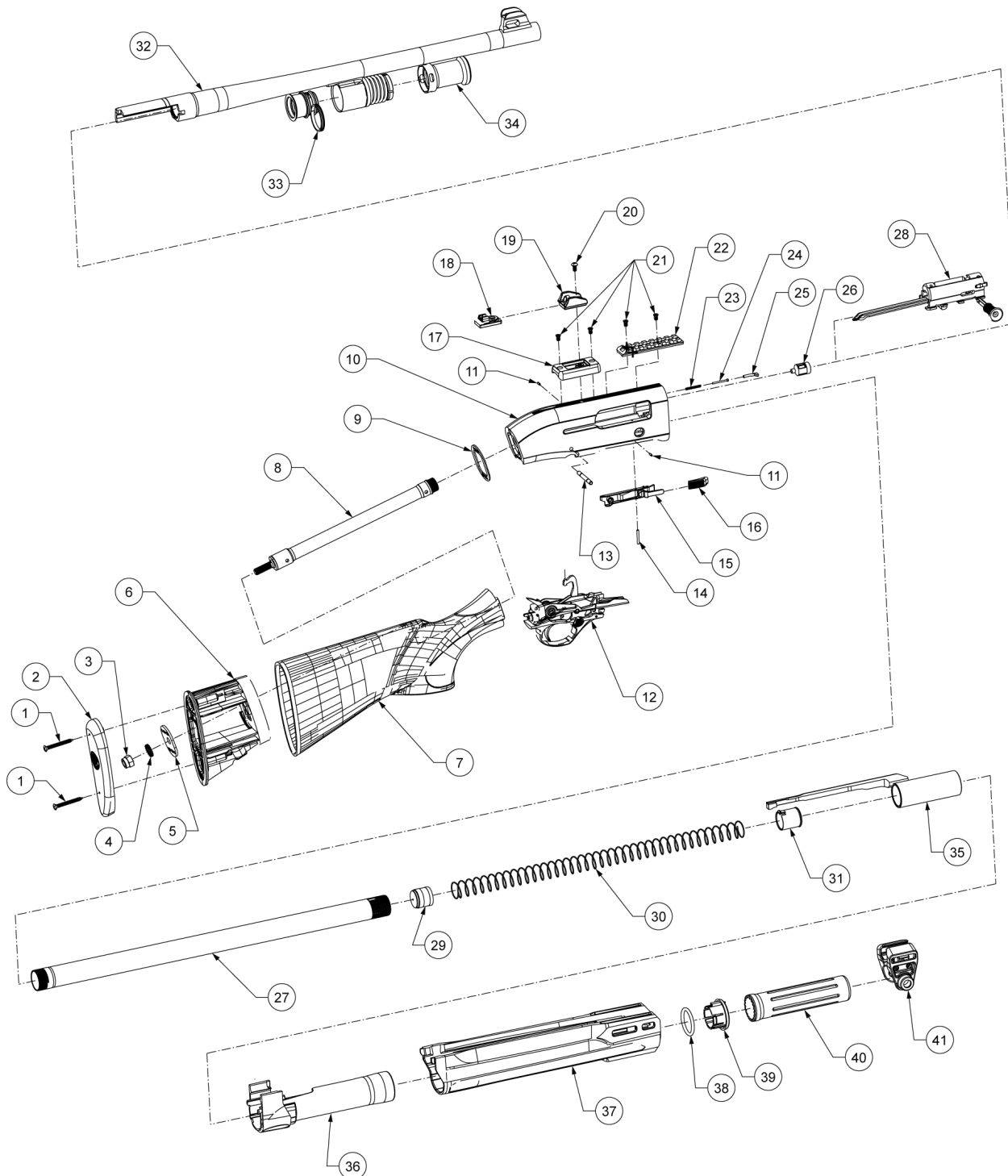

Item	Description	QTY
1	Screw, recoil pad, 40 mm	2
2	Recoil pad, 12 mm	1
3	Nut, STK bolt 390/391/391 XTRMA	1
4	Lock washer	1
5	Drop spacer 50/65	1
6	Stock insert	1
7	Stock with cap assembly	1
8	Recoil assembly, A300 12 GA	1
9	Drop spacer 55/60, 12 GA	1
10	Receiver, A300 Patrol, 12 GA	1
11	Pin, univ, short, A300	2
12	Trigger assembly, black, A300 Ultima 12 GA	1
13	Pin, trigger retention, 12 GA	1
14	Pin, latch cartridge assembly	1
15	Latch, cartridge assembly	1
16	Clover, latch cartridge assembly	1
17	Sight host, rear, A300	1
18	Insert, rear sight, dovetail	1
19	Insert, rear sight, ghost ring	1
20	Insert, fastener, rear sight	1
21	Screw, M4 Torx, T15, screw	4
22	Picatinny rail, 1301 Patrol	1
23	Spring, ejector	1
24	Guide, ejector spring	1
25	Ejector 303/390/391 12/20 GA	1
26	Recoil absorber	1
27	Extended magazine tube	1
28	Bolt assembly, 12 GA	1
29	Follower mag 1301 SKD USE	1
30	Spring, magazine, A300 7rd	1
31	Cap, magazine, 391 Exterma	1
32	A300 AGS, 12 GA, 19" barrel assembly	1
33	AGS piston assembly, 12 GA	1
34	Patrol forend spacer	1
35	Operating rod assembly, A300 TAC, 12 GA	1
36	Forend adapter, A300 TAC, 12 GA	1
37	Forend, A300 Patrol, 12 GA	1
38	O-Ring Patrol forend	1
39	Flange, FE sleeve assembly, 391 Extrema	1
40	Forend cap - 1301 extended	1
41	Barrel clamp assembly - 1301	1





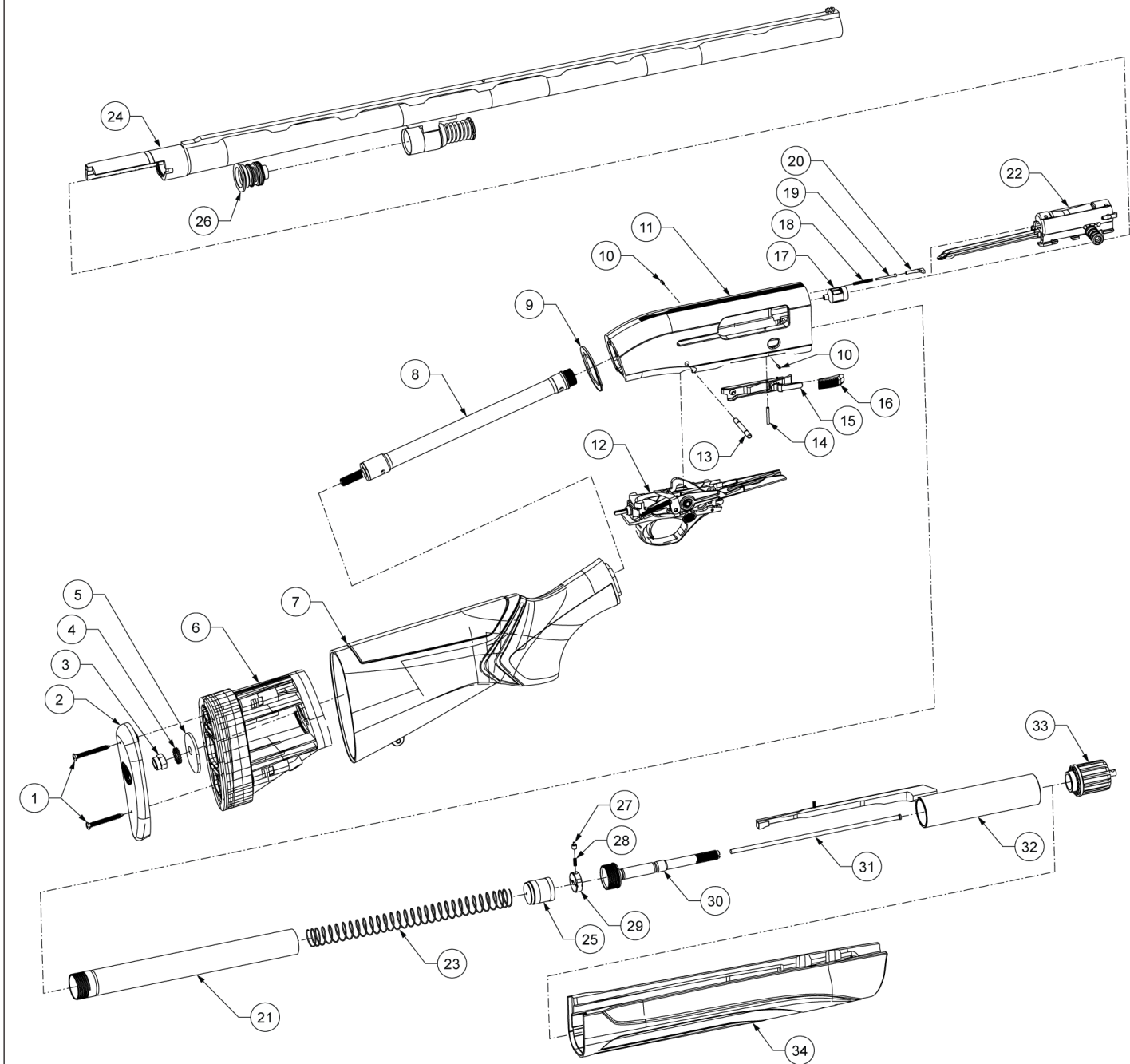



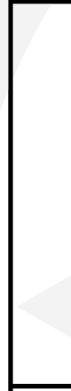

A300 ULTIMA PARTS LIST

A300 ULTIMA

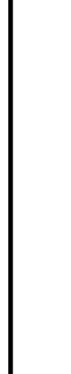
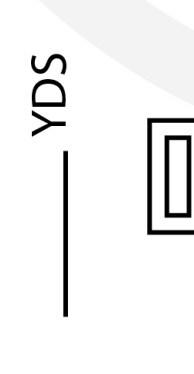

Item	Description	QTY
1	Screw, recoil pad, 40 mm	2
2	Recoil pad, 12 mm	1
3	Nut, stock bolt	1
4	Washer, stock bolt	1
5	Drop spacer, 50/65	1
6	Kick off system, A300 Ultima	1
7	Stock w/cap assembly	1
8	Recoil assembly, A300 12 GA	1
9	Drop spacer, 50/65, 12 GA	1
10	Pin, univ, short, A300	2
11	Receiver, A300 Ultima, 12 GA	1
12	Trigger assembly, A300 Ultima, 12 GA	1
13	Pin, trigger retention, 12 GA	1
14	Pin, latch cartridge assembly	1
15	Latch cartridge assembly	1
16	Cover, latch cartridge assembly	1
17	Recoil absorber	1
18	Spring, ejector	1
19	Guide, ejector spring	1
20	Ejector	1
21	Magazine tube, 12 GA	1
22	Bolt assembly, 12 GA	1
23	Spring, magazine tube, 12 GA	1
24	Barrel assembly, A300 Ultima, 12 GA	1
25	Magazine follower, 12GA	1
26	Piston assembly, 12GA	1
27	Plunger, magazine tube cap plunger	1
28	Spring, magazine tube cap plunger	1
29	Container, magazine tube cap plunger	1
30	Cap, magazine tube	1
31	Plug, magazine limiting	1
32	Operating rod, 12 GA	1
33	Forend cap	1
34	Forend assembly, A300 Ultima, 12 GA	1

PATTERNING AND POA/I CARD

LEGEND				
• BIRD SHOT				
○ BUCK SHOT				
△ SLUG				
+ POINT OF AIM				
_____ YDS	25 YDS	20 YDS	15 YDS	
				
				
				

DATE:



A300
SHOTGUN
USER MANUAL



BERETTA USA
17601 BERETTA DRIVE
ACCOKEEK, MD 20607

BERETTA.COM
1.888.4-Beretta



PROUDLY MADE IN USA